

# CUSTOMISED ALUMINIUM EXTRUSION SOLUTIONS

**ALUKA**  
EXTRUSION

ISO 9001:2015 Certified Company

**ALUKA EXTRUSION INDUSTRIES LLP**



**PRECISION**



**CONSISTENCY**



**DEPENDABILITY**

**BUILT ON DISCIPLINED PROCESSES**

**At Aluka Extrusion Industries LLP**, we specialize in providing high-quality aluminium extrusion solutions tailored to meet the diverse needs of industries worldwide. With years of expertise and a commitment to innovation, we are a leading player in the aluminium extrusion sector, dedicated to delivering precision-engineered products that exceed expectations.



Aluka Extrusion Industries LLP, an ISO 9001:2015 certified company located in Sanand, Gujarat, operates with an annual production capacity of 6,200 metric tonnes.

Our state-of-the-art facilities, cutting-edge technology, and skilled workforce enable us to offer a comprehensive range of custom aluminium profiles, from standard shapes to complex, intricate designs. **We serve industries such as Automotive & Transport, Building & Construction, Electricals & Electronics, Switch Gear, Cryogenic, HVAC, Defence, Textile, Modular Furniture, Pumps & Motor, LED & Lighting, Renewable energy, etc. offering solutions that enhance efficiency, durability, and sustainability.**

Whether you need specific customizations, complex tolerances, or large-volume production, Aluka Extrusion Industries LLP is your reliable partner for top-notch aluminium extrusions. We strive to build long-term relationships with our clients by offering exceptional customer service, timely delivery, and unparalleled product quality.

Discover the potential of aluminium extrusion and let us help bring your projects to life.

## OUR INFRASTRUCTURE

- 1600 UST Hydraulic Extrusion Press that is controlled by microprocessor technology and a programmable logic control (PLC) system
- Imported high-energy efficient Single Log Heater with a hot log shear, ensuring that our extrusions are extruded at a uniform temperature.
- Fully Automatic Puller and Handling System ensures that the profiles come out straight and scratch-free.
- Imported microprocessor-controlled Aging Furnace for heat treatment, ensuring that our extrusions have a uniform temperature and flow of air, ultimately enhancing their mechanical properties.
- Our in-house Melting Furnace is backed up by an imported hot top-casting machine for casting Logs of various alloys.
- Imported Homogenizing furnace. A special machine for heat treatment after log casting, it's aimed to eliminate the remaining stress generated from casting and uneven metallographic structure.
- Automatic Well Type Nitriding Furnace (HydroNit Sensor)
- KEYENCE Make Measuring Machine
- Profile Projector
- Spectroscopy
- UTS
- Ultra Sonic Testing
- Conductivity Meter
- Brinell Hardness Testing Machine

## Alloy & Temper

We manufacture profiles in a range of alloys and tempers, adhering to international standards, including:

- |         |         |         |
|---------|---------|---------|
| • 1050A | • 1060  | • 1070A |
| • 1100  | • 3003  | • 3103  |
| • 6005A | • 6060  | • 6063  |
| • 6061  | • 6082  | • 6351  |
| • 63401 | • 6101B |         |



**Melting Furnace**



**Homogenizing Furnace**



**Automatic Well Type Nitriding Furnace (HydroNit Sensor)**



**1600 UST Extrusion Press With Single Log Heater 2**

## ALUMINIUM ALLOY SPECIFICATION

A. MECHANICAL PROPERTIES								
Alloy Specification		Temper		0.2 Proof Stress Mpa Min.	Ultimate Tensile Strength Mpa Min.	Elongation on 50mm Gauge Min.		Equivalents Alloy
Old	New	Old	New					
EIC	19000	M	F	-	(65)	(18)	20	
EIB	19500	M	F	-	(65)	(23)	18	
HE9	63400	M	F	-	(110)	(13)	-	AA6063
		W	T4	80	140	14	45	
		P	T5	140	170	7	-	
		WP	T6	150	185	7	60	
E91E	63401	W	T4	80	140	12	-	
		WP	T6	135	170	12	55	
HE30	64430	M	F	-	(110)	(14)	-	Equivalents AA 6082 ISO Al Si Mg Mn ASTM 6351
		W	T4	120	185	14	60	
		WP	T6	270	310	7	95	
HE20	65032	M	F	-	(110)	(12)	-	
		W	T4	115	185	14	55	
		WP	T6	235	280	7	85	
-	AA6005	P	T5	240	260	8	80	ASTM B221M
-	AA6060		T4	60	120	16	-	BS : 1474 ISO - Al Mg Si
			T5	100	145	8	-	
			T6	150	190	8	60	
-	AA6061		T4	115	190	16	65	Equivalent ISO AlMg1SiCu
			T6	240	280	8	85	
			T6510					

Note:- No Mechanical Properties are specified in F ( or M ) Condition

The bracketed values are given for information only

1Mpa = 1 N/mm<sup>2</sup> = 0.102 Kgf/mm<sup>2</sup>

Typical BHN values are given for information only and no guarantee is implied.

B. CHEMICAL COMPOSITION IN PERCENTAGE												
Designation	Copper	Magnesium	Silicon	Iron	Manganese	Zinc	Titanium	Chromium	Others		Aluminium	Remarks
	Cu	Mg	Si	Fe	Mn	Zn	Ti	Cr	Each	Total	Al	
19000	0.1	0.2	0.5	0.7	0.1	0.1	-	-	0.05	-	99.0 Min	Ti+v=0.07
19500	0.05	0.05	0.3	0.4	0.05	0.1	-	-	0.03	-	99.5 Min	T+v=0.07
63400	0.1	0.4-0.8	0.3-0.7	0.6	0.3	0.2	0.2	0.1	0.05	0.15	Remainder	
63401	0.05	0.4-0.9	0.3-0.7	0.5	0.03	0.10	0.10	0.03	0.03	0.10	Remainder	
64430	0.1	0.4-1.2	0.6-1.3	0.6	0.4-1.0	0.1	0.2	0.25	0.05	0.15	Remainder	
65032	0.15-0.4	0.7-1.2	0.4-0.8	0.7	0.2-0.8	0.2	0.2	0.15-0.35	0.05	0.15	Remainder	Either Mn or Cr shall be present
AA6005	0.10	0.40-0.60	0.60-0.90	0.35	0.10	0.10	0.10	0.10	0.05	0.15	Remainder	
AA6060	0.10	0.35-0.60	0.30-0.60	0.10-0.30	0.10	0.15	0.10	0.05	0.05	0.15	Remainder	
AA6061	0.15-0.40	0.8-1.20	0.40-0.80	0.7	0.15	0.25	0.15	0.40-0.35	0.05	0.15	Remainder	

Note : Composition in Maximum unless shown as a range or a minimum

## ADVANTAGES OF ALUMINIUM OVER UPVC

- Non-inflammable, non-toxic material
- Great color variety and coating options
- High stability
- High wind resistance and high thermal insulation with thermal break
- High durability
- Slim design, big sizes and flexible structures
- Stable corner connection and fittings attachment

### Durability and Maintenance

- Aluminum windows are durable for up to more than 60 years. They require minimal maintenance. PVC windows are only durable for a maximum period of 25 years. Since it is a soft material, it can easily get scratches and would require exchange of whole vent frame in case of damage.

### Stability/ Wind resistance

- Aluminium has a high stability due to great strength to weight ratio. PVC Windows need steel or aluminium reinforcements to reach the same stability in the same sizes.

### Thermal Insulation

- Aluminium is a good conductor of heat. Implemented thermal break keeps high stability and highly improves the thermal insulation
- For PVC structures, steel reinforcements are needed to improve stability that reduces thermal insulation.

### Color Variety

- Aluminium offers great variety and coating options such as anodizing, wet and powder coating that ultimately offer UV resistance.

### Recycling

- Aluminium does not lose any of its inherent properties even after repeated recycling.
- PVC: The purity of the material degrades with each reuse cycle; recycled material is grey and can only be used in covered areas.

### Fire resistance

- Aluminium is non - inflammable and non-toxic; it has no impact on air or water.
- PVC has low flammability. In case of fire, harmful and life threatening gases like carbon monoxide, carbon dioxide and vinyl chloride are emitted.

### FLAT BARS

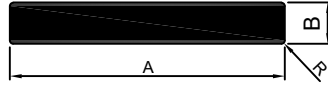

NO	SECTION NO	A	B	R	WT. / MTR.
01	10100	11.00	8.00		0.237 Kg/m.
02	10071	11.13	7.92		0.237 Kg/m.
03	10082	12.00	2.50		0.080 Kg/m.
04	10107	12.70	4.80	0.79	0.163 Kg/m.
05	10144	14.30	12.70	1.60	0.484 Kg/m.
06	10126	14.50	12.00	1.00	0.467 Kg/m.
07	10002	15.75	9.53		0.404 Kg/m.
08	10098	17.00	4.15		0.190 Kg/m.
09	10001	17.00	4.25		0.195 Kg/m.
10	10083	18.00	2.50		0.121 Kg/m.
11	10072	18.54	14.22		0.711 Kg/m.
12	10003	20.00	6.00		0.323 Kg/m.
13	10004	20.00	10.00		0.539 Kg/m.
14	12039	20.00	10.00	3.00	0.519 Kg/m.
15	10096	20.00	12.00		0.647 Kg/m.
16	10121	25.00	1.50		0.100 Kg/m.
17	10079	25.00	2.00		0.135 Kg/m.
18	10005	25.00	3.00		0.202 Kg/m.
19	10106	25.00	5.00		0.337 Kg/m.
20	10145	25.00	5.00	1.25	0.333 Kg/m.
21	10006	25.00	6.00		0.405 Kg/m.
22	12040	25.00	6.00	3.00	0.384 Kg/m.
23	10007	25.00	8.00		0.539 Kg/m.
24	10008	25.00	10.00		0.674 Kg/m.
25	12001	25.00	10.00	3.00	0.654 Kg/m.
26	10010	25.00	16.00		1.087 Kg/m.
27	12002	25.40	12.00	3.00	0.802 Kg/m.
28	10009	25.40	12.70		0.870 Kg/m.
29	10041	25.40	21.40	2.00	1.458 Kg/m.
30	10080	27.50	24.00	1.70	1.775 Kg/m.
31	10095	27.80	24.80		1.861 Kg/m.
32	10049	30.00	5.00	0.50	0.404 Kg/m.
33	10011	30.00	6.00		0.486 Kg/m.
34	10012	30.00	10.00		0.809 Kg/m.
35	12021	30.00	10.00	3.00	0.789 Kg/m.
36	10013	30.00	12.00		0.971 Kg/m.
37	10054	30.00	15.00		1.214 Kg/m.
38	10014	30.00	20.00		1.619 Kg/m.
39	10073	31.75	25.40		2.177 Kg/m.
40	10099	32.00	10.00		0.863 Kg/m.
41	10089	32.00	25.00		2.159 Kg/m.
42	10084	35.00	1.75		0.165 Kg/m.
43	10015	38.00	12.00		1.230 Kg/m.
44	10016	40.00	3.00		0.323 Kg/m.
45	10017	40.00	6.00		0.650 Kg/m.
46	12027	40.00	6.00	3.00	0.627 Kg/m.
47	10050	40.00	8.00	0.50	0.863 Kg/m.
48	10018	40.00	10.00		1.080 Kg/m.

NO	SECTION NO	A	B	R	WT. / MTR.
49	10101	40.00	10.00		1.080 Kg/m.
50	12003	40.00	10.00	3.00	1.059 Kg/m.
51	12004	40.00	12.00	3.00	1.275 Kg/m.
52	10019	40.00	12.50		1.349 Kg/m.
53	10020	40.00	16.00		1.727 Kg/m.
54	10119	41.00	20.00	1.00	2.211 Kg/m.
55	10142	45.00	6.00		0.728 Kg/m.
56	10064	45.00	8.00		0.971 Kg/m.
57	10021	50.00	6.00		0.810 Kg/m.
58	12028	50.00	6.00	3.00	0.789 Kg/m.
59	12035	50.00	7.85	3.00	1.038 Kg/m.
60	10022	50.00	8.00		1.080 Kg/m.
61	10023	50.00	10.00		1.350 Kg/m.
62	10092	50.00	10.00	2.00	1.340 Kg/m.
63	12005	50.00	10.00	3.00	1.329 Kg/m.
64	12006	50.00	12.00	3.00	1.600 Kg/m.
65	10024	50.00	12.50		1.687 Kg/m.
66	10025	50.00	16.00		2.159 Kg/m.
67	10026	50.00	20.00		2.699 Kg/m.
68	10027	50.00	25.00		3.375 Kg/m.
69	10028	50.00	32.00		4.320 Kg/m.
70	10120	50.80	38.10		5.225 Kg/m.
71	10123	51.00	36.50	1.50	5.020 Kg/m.
72	10117	57.00	47.00	1.00	7.230 Kg/m.
73	10102	58.00	14.00		2.192 Kg/m.
74	12026	60.00	6.00	3.00	0.951 Kg/m.
75	12038	60.00	8.00	3.00	1.275 Kg/m.
76	10029	60.00	10.00		1.620 Kg/m.
77	12007	60.00	10.00	3.00	1.600 Kg/m.
78	10074	60.00	12.00	1.00	1.941 Kg/m.
79	10030	63.00	6.00		1.020 Kg/m.
80	10075	63.00	10.00	2.00	1.692 Kg/m.
81	10091	63.00	12.00	2.00	2.031 Kg/m.
82	10097	63.00	16.00		2.721 Kg/m.
83	12008	63.50	12.00	3.00	2.036 Kg/m.
84	10031	63.50	12.70		2.170 Kg/m.
85	10032	63.50	25.40		4.354 Kg/m.
86	10033	63.50	32.00	1.00	5.484 Kg/m.
87	10034	65.00	10.00		1.750 Kg/m.
88	12009	65.00	10.00	3.00	1.734 Kg/m.
89	10035	65.00	12.00	3.00	2.085 Kg/m.
90	10112	70.00	6.00		1.133 Kg/m.
91	10127	75.00	6.00		1.214 Kg/m.
92	12022	75.00	6.00	3.00	1.194 Kg/m.
93	12041	75.00	8.00	3.00	1.599 Kg/m.
94	10036	75.00	10.00	2.00	2.025 Kg/m.
95	12010	75.00	10.00	3.00	2.004 Kg/m.
96	12011	75.00	12.00	3.00	2.409 Kg/m.



### FLAT BARS

PAGE - 03

SECTION NO: 10651

3.454 Kg/m.

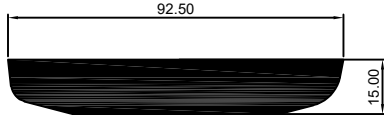

SECTION NO: 10652

3.273 Kg/m.

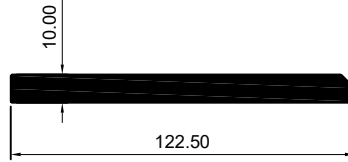

SECTION NO: 10655

1.693 Kg/m.

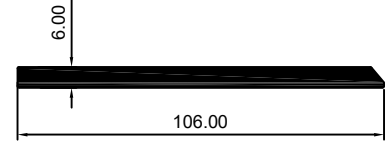

ALUKA  
EXTRUSION

### ROUND BARS

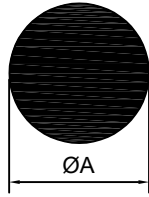

NO	SECTION NO	A	WT. / MTR.
01	10721	7.40	0.116 Kg/m.
02	10737	10.00	0.212 Kg/m.
03	10717	11.00	0.256 Kg/m.
04	10507	12.00	0.305 Kg/m.
05	10724	13.00	0.358 Kg/m.
06	10522	15.00	0.477 Kg/m.
07	10715	17.00	0.612 Kg/m.
08	10701	18.00	0.687 Kg/m.
09	10702	19.05	0.770 Kg/m.
10	10716	20.00	0.848 Kg/m.
11	10500	22.20	1.045 Kg/m.
12	10703	22.20	1.045 Kg/m.
13	10515	24.50	1.272 Kg/m.
14	10899	24.80	1.304 Kg/m.
15	10501	25.00	1.325 Kg/m.
16	10704	25.40	1.368 Kg/m.
17	10744	25.40	1.368 Kg/m.
18	10513	25.40	1.368 Kg/m.
19	10508	26.00	1.433 Kg/m.
20	10509	28.00	1.662 Kg/m.
21	10502	28.50	1.722 Kg/m.
22	10705	28.58	1.730 Kg/m.
23	10747	30.00	1.908 Kg/m.
24	10706	31.75	2.130 Kg/m.
25	10745	32.00	2.171 Kg/m.
26	10503	33.00	2.309 Kg/m.
27	10746	36.00	2.748 Kg/m.
28	10707	38.10	3.080 Kg/m.
29	10708	40.00	3.392 Kg/m.
30	10504	42.00	3.740 Kg/m.
31	10709	45.00	4.290 Kg/m.
32	10749	47.00	4.684 Kg/m.
33	10505	50.00	5.301 Kg/m.
34	10710	50.80	5.470 Kg/m.
35	10711	57.00	6.886 Kg/m.
36	10712	60.00	7.634 Kg/m.
37	10510	60.50	7.761 Kg/m.
38	10506	62.00	8.151 Kg/m.
39	10713	63.50	8.550 Kg/m.
40	10714	65.00	8.954 Kg/m.

### ROUND BARS (EC-GRADE)

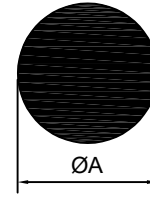

NO	SECTION NO	A	WT. / MTR.
01	10718	8.30	0.146 Kg/m.
02	10518	12.00	0.305 Kg/m.
03	10519	14.00	0.415 Kg/m.
04	10738	16.00	0.542 Kg/m.
05	10739	18.50	0.725 Kg/m.
06	10511	18.50	0.725 Kg/m.
07	10520	19.60	0.814 Kg/m.
08	10722	20.00	0.848 Kg/m.
09	10726	21.00	0.935 Kg/m.
10	10735	22.00	1.026 Kg/m.
11	10727	23.00	1.121 Kg/m.
12	10740	23.00	1.121 Kg/m.
13	10723	24.10	1.231 Kg/m.
14	10719	26.00	1.433 Kg/m.
15	10728	27.00	1.545 Kg/m.
16	10516	28.00	1.662 Kg/m.
17	10741	28.50	1.722 Kg/m.
18	10512	28.50	1.722 Kg/m.
19	10729	29.00	1.783 Kg/m.
20	10736	30.00	1.908 Kg/m.
21	10523	30.90	2.024 Kg/m.
22	10720	32.00	2.171 Kg/m.
23	10514	34.00	2.451 Kg/m.
24	10742	34.00	2.451 Kg/m.
25	10730	35.00	2.597 Kg/m.
26	10725	35.50	2.672 Kg/m.
27	10731	36.00	2.748 Kg/m.
28	10517	38.00	3.062 Kg/m.
29	10743	40.00	3.392 Kg/m.
30	10732	41.50	3.652 Kg/m.
31	10521	44.00	4.105 Kg/m.
32	10733	46.00	4.487 Kg/m.
33	10734	50.00	5.301 Kg/m.
34	10748	55.00	6.414 Kg/m.
35	10711	57.00	6.886 Kg/m.

### SQUARE BARS

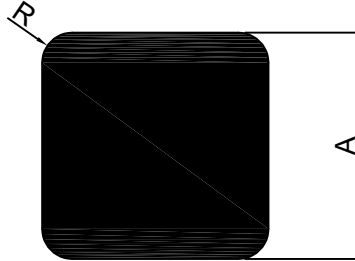

NO	SECTION NO	A	R	WT. / MTR.
01	10752	15.87	0.50	0.679 Kg/m.
02	10753	19.00	0.50	0.974 Kg/m.
03	10751	19.00	2.00	0.965 Kg/m.
04	30093	19.90	4.00	1.032 Kg/m.
05	10758	24.80	0.50	1.660 Kg/m.
06	10754	25.40	0.50	1.741 Kg/m.
07	10762	30.00	CH-1.50	2.417 Kg/m.
08	10766	30.00	1.00	2.427 Kg/m.
09	10755	31.75	0.50	2.720 Kg/m.
10	10763	34.50	0.50	3.213 Kg/m.
11	10764	35.00	0.50	3.306 Kg/m.
12	10756	40.00	0.50	4.319 Kg/m.
13	10759	41.00	0.50	4.538 Kg/m.
14	10761	45.00	0.50	5.467 Kg/m.
15	10757	50.00	0.50	6.750 Kg/m.
16	10765	50.80	0.50	6.967 Kg/m.
17	10760	51.00	0.50	7.022 Kg/m.

### ROUND TUBES

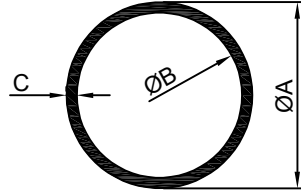

NO	SECTION NO	A	B	C	WT. / MTR.
01	10870	8.30	5.40	-	0.084 Kg/m.
02	10882	9.70	7.00	-	0.095 Kg/m.
03	10883	10.80	8.00	-	0.111 Kg/m.
04	10856	12.00	6.80	-	0.207 Kg/m.
05	10994	12.00	9.00	-	0.133 Kg/m.
06	10884	13.00	9.30	-	0.174 Kg/m.
07	11536	13.40	7.80	-	0.251 Kg/m.
08	11537	13.50	7.90	-	0.254 Kg/m.
09	11522	13.50	10.10	-	0.170 Kg/m.
10	10871	14.50	10.20	-	0.225 Kg/m.
11	10872	15.50	11.30	-	0.238 Kg/m.
12	10921	15.87	-	1.20	0.149 Kg/m.
13	10862	15.875	-	1.20	0.149 Kg/m.
14	10936	15.87	-	1.60	0.193 Kg/m.
15	10889	15.90	7.50	-	0.416 Kg/m.
16	11503	15.90	11.70	-	0.245 Kg/m.
17	11538	16.00	9.90	-	0.335 Kg/m.
18	10837	16.00	11.60	-	0.257 Kg/m.
19	10927	16.40	7.30	-	0.457 Kg/m.
20	10911	16.70	7.40	-	0.475 Kg/m.
21	11504	16.70	12.20	-	0.275 Kg/m.
22	10881	16.90	12.00	-	0.300 Kg/m.
23	11505	17.00	13.00	-	0.254 Kg/m.
24	10838	17.10	12.90	-	0.267 Kg/m.
25	10877	17.40	13.20	-	0.272 Kg/m.
26	10863	18.00	-	1.20	0.171 Kg/m.
27	10922	18.00	-	1.20	0.171 Kg/m.
28	11506	18.80	13.80	-	0.345 Kg/m.
29	10991	19.00	-	1.35	0.202 Kg/m.
30	10885	19.00	13.70	-	0.367 Kg/m.
31	10864	19.05	-	1.20	0.181 Kg/m.
32	10923	19.05	-	1.20	0.181 Kg/m.
33	10801	19.05	-	1.60	0.236 Kg/m.
34	11539	19.30	12.20	-	0.474 Kg/m.
35	10831	19.60	14.80	-	0.350 Kg/m.
36	10900	19.60	15.00	-	0.337 Kg/m.
37	10973	20.00	-	2.00	0.305 Kg/m.
38	10986	20.50	12.30	-	0.570 Kg/m.
39	10890	20.60	8.30	-	0.753 Kg/m.

NO	SECTION NO	A	B	C	WT. / MTR.
40	10891	20.65	10.30	-	0.679 Kg/m.
41	11507	20.90	15.20	-	0.436 Kg/m.
42	10886	21.10	15.10	-	0.460 Kg/m.
43	11508	21.10	16.20	-	0.387 Kg/m.
44	10839	21.20	16.10	-	0.403 Kg/m.
45	10901	21.50	16.50	-	0.402 Kg/m.
46	10857	21.60	16.30	-	0.425 Kg/m.
47	11526	22.00	-	1.50	0.260 Kg/m.
48	10977	22.00	13.20	-	0.656 Kg/m.
49	10865	22.23	-	1.20	0.214 Kg/m.
50	10924	22.23	-	1.20	0.214 Kg/m.
51	11540	23.40	15.00	-	0.684 Kg/m.
52	11509	23.50	18.10	-	0.476 Kg/m.
53	11510	23.70	16.70	-	0.600 Kg/m.
54	10840	23.70	18.00	-	0.504 Kg/m.
55	10873	23.90	16.60	-	0.626 Kg/m.
56	10858	24.00	18.40	-	0.503 Kg/m.
57	10902	24.00	18.60	-	0.487 Kg/m.
58	10888	25.00	-	1.20	0.242 Kg/m.
59	10925	25.00	-	1.20	0.242 Kg/m.
60	11527	25.00	-	1.50	0.300 Kg/m.
61	10866	25.40	-	1.20	0.246 Kg/m.
62	10802	25.40	-	1.60	0.323 Kg/m.
63	10934	25.40	-	2.00	0.396 Kg/m.
64	10829	25.40	-	3.00	0.570 Kg/m.
65	10948	25.40	-	3.20	0.602 Kg/m.
66	10892	25.40	13.00	-	1.009 Kg/m.
67	10851	25.70	12.10	-	1.090 Kg/m.
68	11541	25.70	16.50	-	0.823 Kg/m.
69	11502	26.20	-	4.10	0.775 Kg/m.
70	10928	26.20	12.30	-	1.134 Kg/m.
71	10976	26.00	17.00	-	0.820 Kg/m.
72	10997	26.67	21.33	-	0.543 Kg/m.
73	10906	26.70	19.70	-	0.688 Kg/m.
74	11511	27.00	19.40	-	0.747 Kg/m.
75	10996	27.00	21.00	-	0.610 Kg/m.
76	10887	27.20	19.30	-	0.779 Kg/m.
77	10980	27.70	19.70	-	0.804 Kg/m.
78	11512	27.80	22.10	-	0.603 Kg/m.

### ROUND TUBES

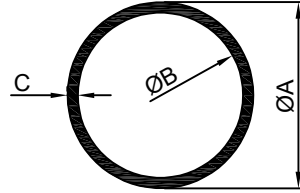

NO	SECTION NO	A	B	C	WT. / MTR.	NO	SECTION NO	A	B	C	WT. / MTR.
79	11528	28.00	-	1.50	0.337 Kg/m.	118	11535	34.20	26.00	-	1.046 Kg/m.
80	10946	28.00	-	1.80	0.400 Kg/m.	119	11514	34.60	25.00	-	1.213 Kg/m.
81	10874	28.00	21.00	-	0.727 Kg/m.	120	10853	34.80	25.00	-	1.242 Kg/m.
82	10832	28.00	22.00	-	0.636 Kg/m.	121	10854	35.00	9.85	-	2.391 Kg/m.
83	10932	28.30	-	3.15	0.672 Kg/m.	122	10907	-	26.20	4.50	1.171 Kg/m.
84	10988	28.50	-	4.10	0.848 Kg/m.	123	11530	-	26.10	4.65	1.212 Kg/m.
85	10867	28.57	-	1.20	0.278 Kg/m.	124	10875	35.50	26.80	-	1.149 Kg/m.
86	10903	28.60	22.00	-	0.708 Kg/m.	125	10880	35.60	26.10	-	1.242 Kg/m.
87	10926	28.60	-	1.20	0.278 Kg/m.	126	10834	36.00	28.00	-	1.085 Kg/m.
88	11500	29.00	17.00	-	1.170 Kg/m.	127	10920	36.70	26.20	-	1.400 Kg/m.
89	11543	29.70	19.70	-	1.047 Kg/m.	128	10989	36.50	23.40	-	1.663 Kg/m.
90	11529	30.00	-	1.50	0.362 Kg/m.	129	10979	37.00	24.50	-	1.630 Kg/m.
91	10850	30.00	12.10	-	1.598 Kg/m.	130	10999	37.30	26.20	-	1.494 Kg/m.
92	10929	30.00	16.00	-	1.365 Kg/m.	131	11534	37.40	23.60	-	1.785 Kg/m.
93	10820	30.00	16.50	-	1.331 Kg/m.	132	10943	37.50	29.00	-	1.198 Kg/m.
94	11544	30.00	17.00	-	1.295 Kg/m.	133	10855	38.00	14.85	-	2.594 Kg/m.
95	10995	30.00	19.00	-	1.143 Kg/m.	134	10942	38.00	16.00	-	3.263 Kg/m.
96	11513	30.00	21.90	-	0.891 Kg/m.	135	10908	38.00	23.00	-	1.940 Kg/m.
97	10937	-	22.00	4.00	0.882 Kg/m.	136	10972	38.00	24.00	-	1.840 Kg/m.
98	10971	30.10	19.40	-	1.123 Kg/m.	137	10876	38.00	26.00	-	1.628 Kg/m.
99	10893	30.15	16.60	-	1.343 Kg/m.	138	10835	38.00	27.00	-	1.516 Kg/m.
100	11542	30.20	19.30	-	1.144 Kg/m.	139	10830	38.00	34.30	-	0.567 Kg/m.
101	10852	30.20	21.80	-	0.926 Kg/m.	140	11515	39.00	28.30	-	1.527 Kg/m.
102	10894	30.40	16.00	-	1.416 Kg/m.	141	10935	39.10	28.20	-	1.555 Kg/m.
103	11531	30.70	13.70	-	1.600 Kg/m.	142	10805	40.00	-	2.50	0.795 Kg/m.
104	10978	31.00	20.00	-	1.189 Kg/m.	143	10804	40.00	-	3.00	0.941 Kg/m.
105	10833	31.00	24.00	-	0.816 Kg/m.	144	10806	40.00	-	5.00	1.484 Kg/m.
106	10859	31.20	21.80	-	1.056 Kg/m.	145	11523	40.50	26.20	-	2.022 Kg/m.
107	10896	-	22.90	4.50	1.045 Kg/m.	146	10898	41.00	27.00	-	2.018 Kg/m.
108	11532	32.00	23.00	-	1.049 Kg/m.	147	10847	41.00	29.00	-	1.781 Kg/m.
109	10803	32.00	-	4.00	0.950 Kg/m.	148	10848	41.00	30.00	-	1.656 Kg/m.
110	10904	32.00	25.00	-	0.846 Kg/m.	149	10905	41.00	31.00	-	1.526 Kg/m.
111	10974	32.00	-	3.00	0.738 Kg/m.	150	10868	42.00	38.00	-	0.678 Kg/m.
112	10940	32.35	-	4.75	1.112 Kg/m.	151	10836	43.00	27.00	-	2.375 Kg/m.
113	11501	33.00	18.00	-	1.622 Kg/m.	152	10897	43.50	27.50	-	2.408 Kg/m.
114	10987	33.50	21.30	-	1.417 Kg/m.	153	10938	44.60	29.00	-	2.434 Kg/m.
115	10970	33.73	24.33	-	1.157 Kg/m.	154	11516	44.20	31.80	-	1.998 Kg/m.
116	10895	34.00	23.30	-	1.300 Kg/m.	155	10993	44.20	33.00	-	1.833 Kg/m.
117	10947	34.00	23.30	-	1.300 Kg/m.	156	10878	44.40	31.70	-	2.049 Kg/m.

### ROUND TUBES

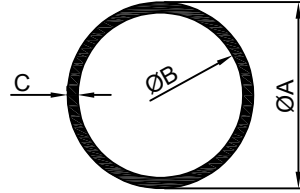

NO	SECTION NO	A	B	C	WT. / MTR.	NO	SECTION NO	A	B	C	WT. / MTR.
157	10807	45.00	-	5.00	1.696 Kg/m.	196	10816	88.90	-	9.00	6.100 Kg/m.
158	10844	46.00	35.00	-	1.890 Kg/m.	197	10815	89.00	-	6.35	4.450 Kg/m.
159	10849	46.00	36.00	-	1.738 Kg/m.	198	10827	93.00	-	3.00	2.290 Kg/m.
160	11545	47.00	32.00	-	2.512 Kg/m.	199	10913	99.00	90.00	-	3.607 Kg/m.
161	10930	48.00	31.00	-	2.847 Kg/m.	200	10817	101.60	-	3.00	2.500 Kg/m.
162	10941	48.20	40.00	-	1.533 Kg/m.	201	10818	101.60	-	5.74	4.667 Kg/m.
163	10842	-	45.00	2.45	0.986 Kg/m.	202	10819	101.60	-	6.35	5.130 Kg/m.
164	10998	50.00	32.00	-	3.130 Kg/m.	203	10821	102.50	-	7.00	5.670 Kg/m.
165	10981	50.00	45.00	-	1.007 Kg/m.	204	10918	105.00	-	13.50	10.477 Kg/m.
166	10808	50.00	-	5.00	1.908 Kg/m.	205	10828	109.00	-	3.00	2.697 Kg/m.
167	10916	50.50	-	12.75	4.082 Kg/m.	206	10822	114.20	-	6.10	5.600 Kg/m.
168	10869	51.00	39.00	-	2.290 Kg/m.	207	10950	114.30	-	8.50	7.628 Kg/m.
169	11533	53.00	35.00	-	3.358 Kg/m.	208	10919	120.00	-	8.00	7.600 Kg/m.
170	10909	54.00	34.00	-	3.732 Kg/m.	209	10823	120.00	-	10.00	9.330 Kg/m.
171	10910	54.00	34.00	-	3.732 Kg/m.	210	10860	122.00	-	6.00	5.903 Kg/m.
172	10982	55.00	50.00	-	1.113 Kg/m.	211	10992	125.00	119.00	-	3.104 Kg/m.
173	10879	55.50	-	5.20	2.218 Kg/m.	212	10824	127.00	-	6.35	6.490 Kg/m.
174	10944	55.50	23.50	-	5.360 Kg/m.	213	10825	127.00	-	9.50	9.468 Kg/m.
175	11517	55.80	41.20	-	3.003 Kg/m.	214	10915	138.00	-	6.50	7.250 Kg/m.
176	10845	56.00	41.00	-	3.085 Kg/m.	215	10912	150.00	-	7.00	8.490 Kg/m.
177	10914	57.00	43.50	-	2.877 Kg/m.	216	10841	-	152.00	4.10	5.428 Kg/m.
178	10846	57.00	43.50	-	2.877 Kg/m.	217	10931	-	152.40	4.10	5.442 Kg/m.
179	10861	60.00	55.00	-	1.219 Kg/m.						
180	10809	60.00	-	5.00	2.331 Kg/m.						
181	10983	60.30	49.50	-	2.514 Kg/m.						
182	10949	63.00	-	5.00	2.459 Kg/m.						
183	10811	63.00	-	8.00	3.734 Kg/m.						
184	10810	63.05	-	6.35	3.078 Kg/m.						
185	10990	75.00	70.00	-	1.537 Kg/m.						
186	10975	76.00	-	3.00	1.857 Kg/m.						
187	10843	76.00	50.00	-	6.497 Kg/m.						
188	10812	76.20	-	6.35	3.762 Kg/m.						
189	10813	76.20	-	9.50	5.374 Kg/m.						
190	10826	77.00	-	3.00	1.883 Kg/m.						
191	10933	80.00	-	5.00	3.180 Kg/m.						
192	10917	80.00	60.00	-	5.937 Kg/m.						
193	10939	82.00	-	7.75	4.881 Kg/m.						
194	10814	82.50	-	3.25	2.184 Kg/m.						
195	10984	88.90	-	7.62	5.253 Kg/m.						

### SPECIAL ROUND TUBES

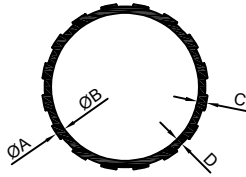

NO	SECTION NO	A	B	C	D	WT. / MTR.
01	10951	100.00	89.00	5.50	4.00	3.759 Kg/m.
02	10952	125.00	114.00	5.50	4.00	4.764 Kg/m.

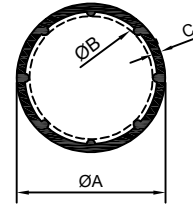

NO	SECTION NO	A	B	C	WT. / MTR.
01	10953	101.60	84.12	5.74	4.970 Kg/m.
02	10959	122.00	105.00	5.00	5.374 Kg/m.
03	10957	125.00	105.00	5.50	6.301 Kg/m.
04	10958	127.00	110.00	5.50	5.971 Kg/m.

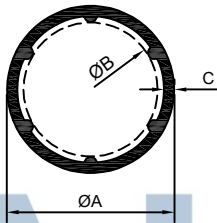

NO	SECTION NO	A	B	C	WT. / MTR.
01	10954	80.00	64.00	5.00	3.406 Kg/m.
02	10955	76.00	63.00	4.00	2.656 Kg/m.
03	10956	89.00	76.00	4.00	3.102 Kg/m.

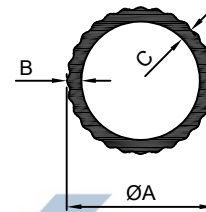

NO	SECTION NO	A	B	C	WT. / MTR.
01	11101	25.40	2.50	2.00	0.434 Kg/m.
02	11102	25.40	2.35	1.60	0.357 Kg/m.
*03	11103	28.30	1.50	1.10	0.295 Kg/m.

\* EXCLUSIVE

SECTION NO: 10960

4.718 Kg/m.

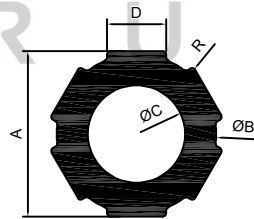
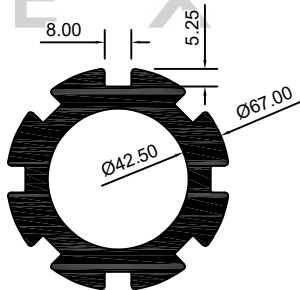

NO	SECTION NO	A	B	C	D	R	WT. / MTR.
01	10961	38.00	36.00	14.50	12.00	0.80	2.560 Kg/m.
02	10962	42.00	40.00	19.50	15.00	0.80	2.943 Kg/m.
03	10963	50.00	48.00	25.50	19.00	1.00	4.007 Kg/m.
04	10964	56.00	54.00	33.00	20.00	1.20	4.396 Kg/m.
05	10965	50.00	49.00	16.55	19.00	0.50	4.856 Kg/m.

\* EXCLUSIVE

### HEXAGONAL TUBES

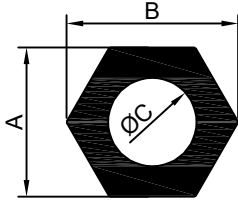

NO	SECTION NO	A	B	C	WT. / MTR.
01	11007	19.00	21.82	8.00	0.708 Kg/m.
02	11008	22.00	25.28	10.00	0.919 Kg/m.
03	11009	27.00	31.02	12.00	1.399 Kg/m.
04	11002	27.00	31.05	16.00	1.162 Kg/m.
05	11005	27.30	31.06	15.00	1.263 Kg/m.
06	11001	32.00	36.83	19.00	1.630 Kg/m.
07	11004	35.00	40.29	15.80	2.334 Kg/m.
08	11003	38.00	43.87	25.00	2.050 Kg/m.
09	11006	38.30	43.82	22.00	2.402 Kg/m.
10	11010	48.00	-	33.00	3.077 Kg/m.
11	11012	50.80	-	30.70	3.978 Kg/m.
12	11011	55.00	-	35.00	4.474 Kg/m.
13	11013	57.15	-	33.50	5.178 Kg/m.
14	11014	72.00	-	42.80	7.771 Kg/m.
15	11015	72.00	-	48.50	6.668 Kg/m.

### HEXAGONAL BARS

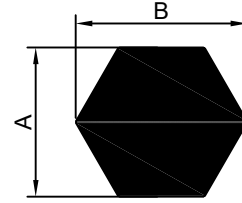

NO	SECTION NO	A	B	WT. / MTR.
01	11203	14.00	16.01	0.458 Kg/m.
02	11212	14.30	-	0.477 Kg/m.
03	11201	16.00	18.35	0.598 Kg/m.
04	11209	17.00	-	0.675 Kg/m.
05	11211	18.80	-	0.826 Kg/m.
06	11210	19.00	-	0.843 Kg/m.
07	11208	19.30	22.13	0.870 Kg/m.
08	11202	25.00	28.74	1.461 Kg/m.
09	11204	27.00	31.05	1.704 Kg/m.
10	11205	32.00	36.83	2.394 Kg/m.
11	11206	36.00	41.45	3.030 Kg/m.
12	11207	50.00	57.61	5.845 Kg/m.

### LUG PROFILES

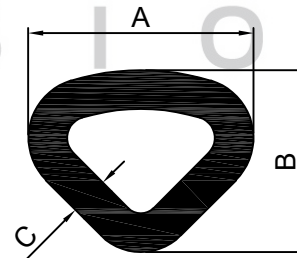

NO	SECTION NO	A	B	C	WT. / MTR.
01	11301	14.00	11.30	2.40	0.206 Kg/m.
02	11302	15.80	12.70	2.30	0.226 Kg/m.
03	11303	18.50	15.00	2.70	0.318 Kg/m.
04	11304	21.00	17.00	3.00	0.394 Kg/m.
05	11305	23.70	19.00	3.50	0.522 Kg/m.
06	11306	26.50	21.50	3.80	0.632 Kg/m.
07	11307	29.00	23.00	4.50	0.813 Kg/m.
08	11308	33.50	27.00	4.50	0.956 Kg/m.
09	11309	39.30	31.00	6.00	1.447 Kg/m.



### SQUARE TUBES

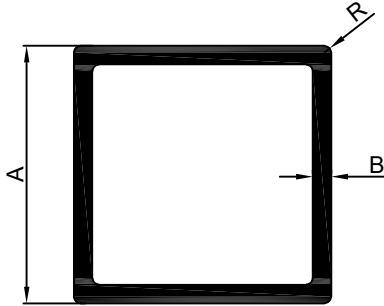

### SPECIAL TUBES

SECTION NO: 20551

0.785 Kg/m.

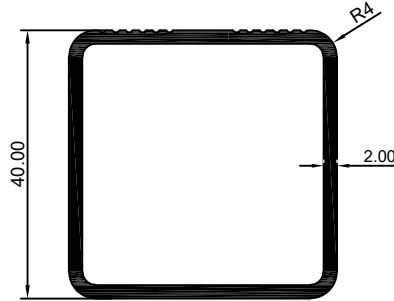

SECTION NO: 20552

1.787 Kg/m.

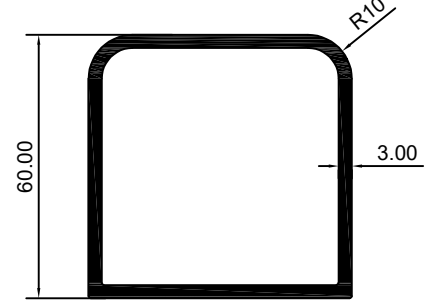

NO.	SEC. NO.	A	B	R	WT./MTR.
01	20518	16.00	1.20		0.191 Kg/m.
02	20517	18.00	1.80		0.314 Kg/m.
03	20501	19.00	1.60		0.300 Kg/m.
04	20511	20.00	2.00		0.388 Kg/m.
05	20521	20.00	3.00	4.00	0.516 Kg/m.
06	20502	25.00	1.50		0.380 Kg/m.
07	20510	25.00	3.00		0.712 Kg/m.
08	20514	30.00	2.00	4.00	0.576 Kg/m.
09	20503	34.00	1.50	3.00	0.510 Kg/m.
10	20504	38.00	1.50		0.610 Kg/m.
11	20509	38.00	1.63		0.640 Kg/m.
12	20522	38.00	2.00		0.777 Kg/m.
13	20512	38.10	3.00		1.137 Kg/m.
14	20523	38.10	3.175	7.938	1.104 Kg/m.
15	20520	40.00	1.80		0.742 Kg/m.
16	20505	40.00	2.00	4.00	0.792 Kg/m.
17	20515	40.00	4.00	4.00	1.555 Kg/m.
18	20524	44.45	2.540	11.113	1.033 Kg/m.
19	20506	50.00	1.50		0.785 Kg/m.
20	20507	50.00	2.00		1.037 Kg/m.
21	20508	50.00	3.00		1.522 Kg/m.
22	20528	50.00	4.00	4.00	1.959 Kg/m.
23	20519	75.00	1.80		1.423 Kg/m.
24	20513	80.00	1.50		1.271 Kg/m.
25	20525	80.00	4.00	1.00	3.283 Kg/m.
26	20516	100.00	2.00		2.116 Kg/m.
27	20527	100.00	3.00		3.142 Kg/m.
28	20526	100.00	4.00	1.00	4.147 Kg/m.

SECTION NO: 20554

1.161 Kg/m.

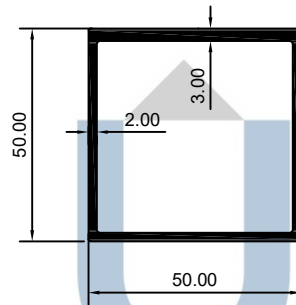

SECTION NO: 20555

0.891 Kg/m.

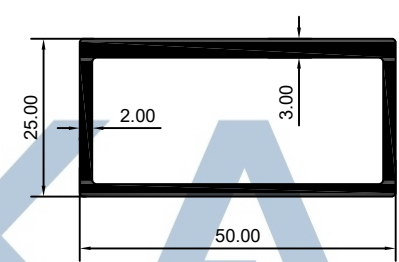

SECTION NO: 20556

1.368 Kg/m.

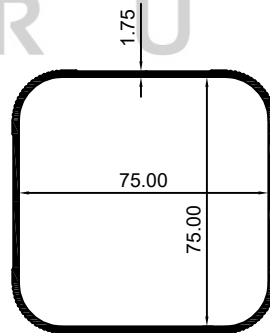

### EQUAL ANGLES

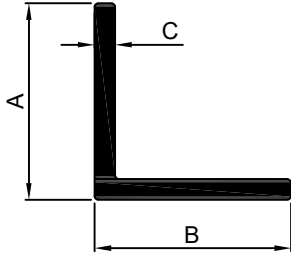

NO.	SEC. NO.	A	B	C	WT./MTR.
01	20601	19.00	19.00	2.00	0.194 Kg/m.
02	20602	25.00	25.00	2.00	0.258 Kg/m.
03	20603	25.00	25.00	3.00	0.380 Kg/m.
04	20604	30.00	30.00	2.50	0.387 Kg/m.
05	20615	30.00	30.00	4.00	0.604 Kg/m.
06	20610	31.75	31.75	2.38	0.394 Kg/m.
07	20619	38.00	38.00	2.00	0.400 Kg/m.
08	20605	38.00	38.00	3.00	0.591 Kg/m.
09	20611	40.00	40.00	5.00	1.011 Kg/m.
10	20606	40.00	40.00	6.50	1.289 Kg/m.
11	20620	50.00	50.00	2.00	0.528 Kg/m.
12	20607	50.00	50.00	3.00	0.786 Kg/m.
13	20613	50.00	50.00	5.00	1.281 Kg/m.
14	20608	50.80	50.80	6.00	1.548 Kg/m.
15	20618	65.00	65.00	2.00	0.661 Kg/m.
16	20609	65.00	65.00	4.25	1.442 Kg/m.
17	20616	75.00	75.00	5.00	1.956 Kg/m.
18	20612	100.00	100.00	6.00	3.142 Kg/m.
19	20614	100.00	100.00	12.00	6.090 Kg/m.
20	20617	101.60	101.60	9.53	4.978 Kg/m.

### UNEQUAL ANGLES

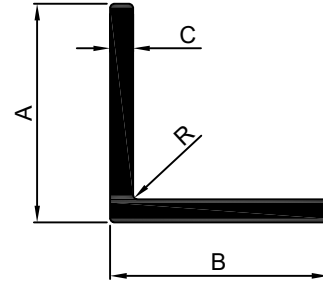

NO.	SEC. NO.	A	B	C	R	WT./MTR.
01	20633	18.00	19.50	2.00		0.191 Kg/m.
02	20632	18.20	19.00	1.40	1.00	0.131 Kg/m.
03	20625	31.75	25.00	2.50		0.365 Kg/m.
04	20631	63.50	50.80	6.35	6.00	1.870 Kg/m.
05	20630	70.00	20.00	2.00		0.474 Kg/m.
06	20628	70.00	62.50	10.00	10.00	3.359 Kg/m.
07	20627	76.20	50.80	6.35	6.86	2.095 Kg/m.
08	20626	101.60	50.80	6.35	6.35	2.527 Kg/m.
09	20634	125.00	50.00	2.00		0.933 Kg/m.

### C-CHANNEL SECTIONS

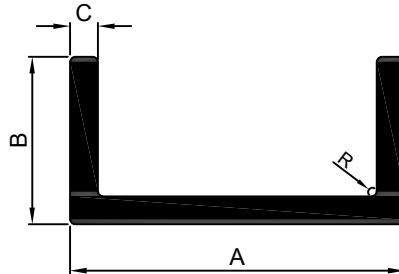

NO	SECTION NO	A	B	C	R	WT. / MTR.
01	20651	12.00	12.00	1.10		0.100 Kg/m.
02	20672	20.00	30.00	1.30		0.271 Kg/m.
03	20664	25.00	50.00	2.50		0.809 Kg/m.
04	20665	40.00	75.00	8.00		3.758 Kg/m.
05	20652	50.00	25.00	2.00		0.518 Kg/m.
06	20656	50.00	25.00	5.00		1.215 Kg/m.
07	20670	53.40	17.75	2.00	0.50	0.457 Kg/m.
08	20653	54.50	50.00	2.00		0.812 Kg/m.
09	20657	58.00	25.00	3.00		0.825 Kg/m.
10	20658	67.00	25.00	3.00		0.898 Kg/m.
11	20666	70.00	80.00	12.00		6.674 Kg/m.
12	20667	70.00	105.00	12.00		8.294 Kg/m.
13	20663	75.00	35.00	5.00	3.00	1.832 Kg/m.
14	20660	75.00	40.00	5.00		1.956 Kg/m.
15	20659	76.00	25.00	3.00		0.971 Kg/m.
16	20654	76.20	38.10	6.35	1.00	2.392 Kg/m.
17	20661	100.00	50.00	6.00	4.00	3.063 Kg/m.
18	20662	100.00	50.00	8.00	6.00	4.015 Kg/m.
19	20669	101.60	50.80	7.60	9.14	3.601 Kg/m.
20	20655	101.60	50.80	7.94	9.14	3.744 Kg/m.
21	20671	140.00	70.00	8.00	1.50	5.697 Kg/m.

# BUILT FOR INDUSTRIES THAT VALUE PREDICTABILITY

Automotive & Auto Components  
LED & Electrical Applications  
Industrial & Engineering Applications

Architectural & Structural Systems  
Defence & Specialised Projects  
Solar & Energy Solutions

If you are evaluating **Aluminium Extrusion Partners**, start with the right technical conversations.

Connect with our engineering team.

## WHY BUYERS CHOOSE US?

Consistency beyond first approvals and samples  
Clear communication across development and production  
Controlled processes that reduce rework and delivery risk  
A long-term, partnership-led manufacturing approach



### ISO 9001:2015



### IATF 16949:2016



### ZED GOLD



**ALUKA**  
EXTRUSION

Customised Aluminium Extrusion Solutions

FACTORY: Survey No. 783/P, Nr. Freight Systems, Mankol-Makhivav Road, Sanand-Nalsarovar Road, Sanand, A'bad - 382110  
OFFICE: B 305, Titanium Heights, Opp. Vodafone Tower, Corporate Road, Ahmedabad - 380015. Gujarat. India.

+91 79 48992145 | [info@alukaextrusion.com](mailto:info@alukaextrusion.com) | [www.alukaextrusion.com](http://www.alukaextrusion.com)