

CUSTOMISED ALUMINIUM EXTRUSION SOLUTIONS

ALUKA
EXTRUSION

ISO 9001:2015 Certified Company

ALUKA EXTRUSION INDUSTRIES LLP



PRECISION



CONSISTENCY



DEPENDABILITY

BUILT ON DISCIPLINED PROCESSES

At Aluka Extrusion Industries LLP, we specialize in providing high-quality aluminium extrusion solutions tailored to meet the diverse needs of industries worldwide. With years of expertise and a commitment to innovation, we are a leading player in the aluminium extrusion sector, dedicated to delivering precision-engineered products that exceed expectations.



Aluka Extrusion Industries LLP, an ISO 9001:2015 certified company located in Sanand, Gujarat, operates with an annual production capacity of 6,200 metric tonnes.

Our state-of-the-art facilities, cutting-edge technology, and skilled workforce enable us to offer a comprehensive range of custom aluminium profiles, from standard shapes to complex, intricate designs. **We serve industries such as Automotive & Transport, Building & Construction, Electricals & Electronics, Switch Gear, Cryogenic, HVAC, Defence, Textile, Modular Furniture, Pumps & Motor, LED & Lighting, Renewable energy, etc. offering solutions that enhance efficiency, durability, and sustainability.**

Whether you need specific customizations, complex tolerances, or large-volume production, Aluka Extrusion Industries LLP is your reliable partner for top-notch aluminium extrusions. We strive to build long-term relationships with our clients by offering exceptional customer service, timely delivery, and unparalleled product quality.

Discover the potential of aluminium extrusion and let us help bring your projects to life.

OUR INFRASTRUCTURE

- 1600 UST Hydraulic Extrusion Press that is controlled by microprocessor technology and a programmable logic control (PLC) system
- Imported high-energy efficient Single Log Heater with a hot log shear, ensuring that our extrusions are extruded at a uniform temperature.
- Fully Automatic Puller and Handling System ensures that the profiles come out straight and scratch-free.
- Imported microprocessor-controlled Aging Furnace for heat treatment, ensuring that our extrusions have a uniform temperature and flow of air, ultimately enhancing their mechanical properties.
- Our in-house Melting Furnace is backed up by an imported hot top-casting machine for casting Logs of various alloys.
- Imported Homogenizing furnace. A special machine for heat treatment after log casting, it's aimed to eliminate the remaining stress generated from casting and uneven metallographic structure.
- Automatic Well Type Nitriding Furnace (HydroNit Sensor)
- KEYENCE Make Measuring Machine
- Profile Projector
- Spectroscopy
- UTS
- Ultra Sonic Testing
- Conductivity Meter
- Brinell Hardness Testing Machine

Alloy & Temper

We manufacture profiles in a range of alloys and tempers, adhering to international standards, including:

- | | | |
|---------|---------|---------|
| • 1050A | • 1060 | • 1070A |
| • 1100 | • 3003 | • 3103 |
| • 6005A | • 6060 | • 6063 |
| • 6061 | • 6082 | • 6351 |
| • 63401 | • 6101B | |



Melting Furnace



Homogenizing Furnace



Automatic Well Type Nitriding Furnace (HydroNit Sensor)



1600 UST Extrusion Press With Single Log Heater 2

ALUMINIUM ALLOY SPECIFICATION

A. MECHANICAL PROPERTIES									
Alloy Specification		Temper		0.2 Proof Stress Mpa Min.	Ultimate Tensile Strength Mpa Min.	Elongation on 50mm Gauge Min.		Equivalents Alloy	
Old	New	Old	New						
EIC	19000	M	F	-	(65)	(18)	20		
EIB	19500	M	F	-	(65)	(23)	18		
HE9	63400	M	F	-	(110)	(13)	-	AA6063	
		W	T4	80	140	14	45		
		P	T5	140	170	7	-		
		WP	T6	150	185	7	60		
E91E	63401	W	T4	80	140	12			
		WP	T6	135	170	12	55		
HE30	64430	M	F	-	(110)	(14)	-	Equivalents AA 6082 ISO Al Si Mg Mn ASTM 6351	
		W	T4	120	185	14	60		
		WP	T6	270	310	7	95		
HE20	65032	M	F	-	(110)	(12)	-		
		W	T4	115	185	14	55		
		WP	T6	235	280	7	85		
-	AA6005	P	T5	240	260	8	80	ASTM B221M	
-	AA6060		T4	60	120	16	-	BS : 1474 ISO - Al Mg Si	
			T5	100	145	8			
			T6	150	190	8	60		
-	AA6061		T4	115	190	16	65	Equivalent ISO AlMg1SiCu	
			T6	240	280	8	85		
			T6510						

Note:- No Mechanical Properties are specified in F (or M) Condition

The bracketed values are given for information only

1Mpa = 1 N/mm² = 0.102 Kgf/mm²

Typical BHN values are given for information only and no guarantee is implied.

B. CHEMICAL COMPOSITION IN PERCENTAGE												
Designation	Copper	Magnesium	Silicon	Iron	Manganese	Zinc	Titanium	Chromium	Others		Aluminium	Remarks
	Cu	Mg	Si	Fe	Mn	Zn	Ti	Cr	Each	Total	Al	
19000	0.1	0.2	0.5	0.7	0.1	0.1	-	-	0.05	-	99.0 Min	Ti+v=0.07
19500	0.05	0.05	0.3	0.4	0.05	0.1	-	-	0.03	-	99.5 Min	T+v=0.07
63400	0.1	0.4-0.8	0.3-0.7	0.6	0.3	0.2	0.2	0.1	0.05	0.15	Remainder	
63401	0.05	0.4-0.9	0.3-0.7	0.5	0.03	0.10	0.10	0.03	0.03	0.10	Remainder	
64430	0.1	0.4-1.2	0.6-1.3	0.6	0.4-1.0	0.1	0.2	0.25	0.05	0.15	Remainder	
65032	0.15-0.4	0.7-1.2	0.4-0.8	0.7	0.2-0.8	0.2	0.2	0.15-0.35	0.05	0.15	Remainder	Either Mn or Cr shall be present
AA6005	0.10	0.40-0.60	0.60-0.90	0.35	0.10	0.10	0.10	0.10	0.05	0.15	Remainder	
AA6060	0.10	0.35-0.60	0.30-0.60	0.10-0.30	0.10	0.15	0.10	0.05	0.05	0.15	Remainder	
AA6061	0.15-0.40	0.8-1.20	0.40-0.80	0.7	0.15	0.25	0.15	0.40-0.35	0.05	0.15	Remainder	

Note : Composition in Maximum unless shown as a range or a minimum

ADVANTAGES OF ALUMINIUM OVER UPVC

- Non-inflammable, non-toxic material
- Great color variety and coating options
- High stability
- High wind resistance and high thermal insulation with thermal break
- High durability
- Slim design, big sizes and flexible structures
- Stable corner connection and fittings attachment

Durability and Maintenance

- Aluminum windows are durable for up to more than 60 years. They require minimal maintenance. PVC windows are only durable for a maximum period of 25 years. Since it is a soft material, it can easily get scratches and would require exchange of whole vent frame in case of damage.

Stability/ Wind resistance

- Aluminium has a high stability due to great strength to weight ratio. PVC Windows need steel or aluminium reinforcements to reach the same stability in the same sizes.

Thermal Insulation

- Aluminium is a good conductor of heat. Implemented thermal break keeps high stability and highly improves the thermal insulation
- For PVC structures, steel reinforcements are needed to improve stability that reduces thermal insulation.

Color Variety

- Aluminium offers great variety and coating options such as anodizing, wet and powder coating that ultimately offer UV resistance.

Recycling

- Aluminium does not lose any of its inherent properties even after repeated recycling.
- PVC: The purity of the material degrades with each reuse cycle; recycled material is grey and can only be used in covered areas.

Fire resistance

- Aluminium is non - inflammable and non-toxic; it has no impact on air or water.
- PVC has low flammability. In case of fire, harmful and life threatening gases like carbon monoxide, carbon dioxide and vinyl chloride are emitted.

TEXTILE SECTIONS

SECTION NO: 31002

1.680 Kg/m.

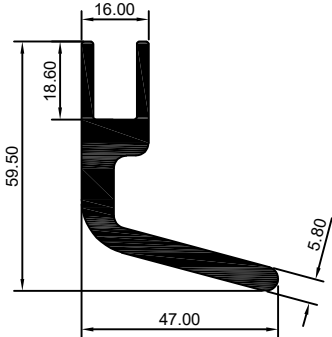

SECTION NO: 31005

2.210 Kg/m.

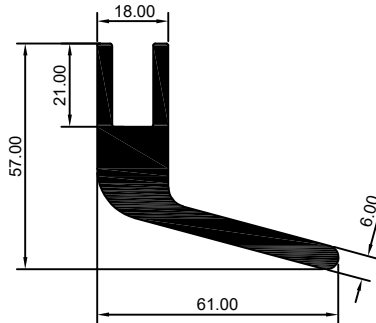

SECTION NO: 31031

2.684 Kg/m.

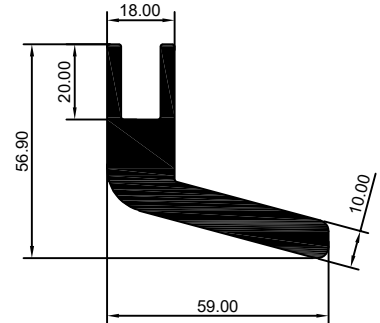

SECTION NO: 31001

0.426 Kg/m.

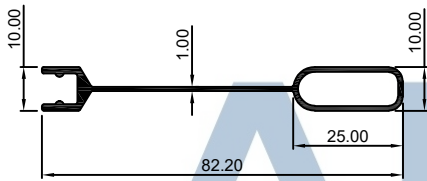

SECTION NO: 31007

2.016 Kg/m.

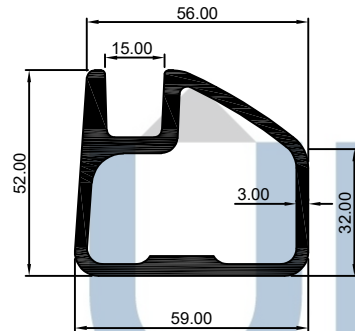

SECTION NO: 31033

2.169 Kg/m.

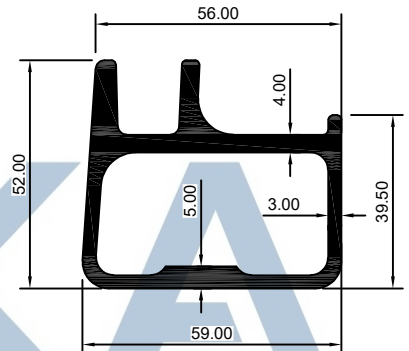

SECTION NO: 31013

2.051 Kg/m.

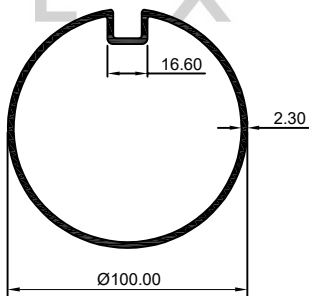

SECTION NO: 31024

0.889 Kg/m.

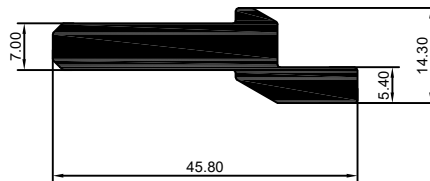

SECTION NO: 31027

6.750 Kg/m.

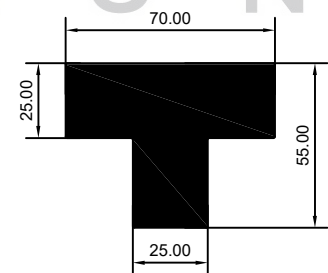

SECTION NO: 31028

1.427 Kg/m.

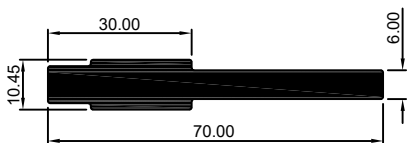

SECTION NO: 31037

1.276 Kg/m.

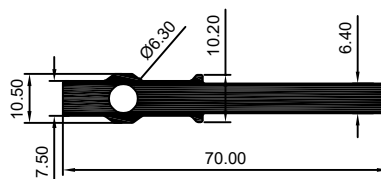

SECTION NO: 31041

3.180 Kg/m.

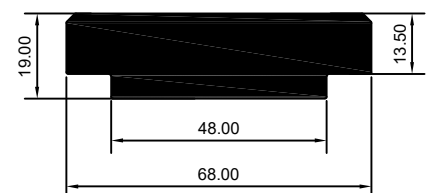

TEXTILE SECTIONS

SECTION NO: 31046

2.333 Kg/m.

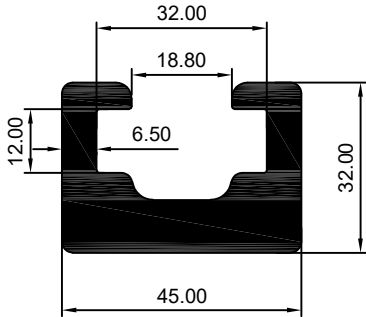

SECTION NO: 32630

0.777 Kg/m.

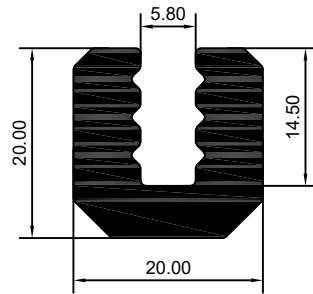

SECTION NO: 31003

0.293 Kg/m.

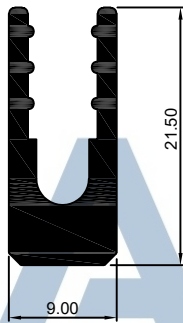

SECTION NO: 31018

0.261 Kg/m.

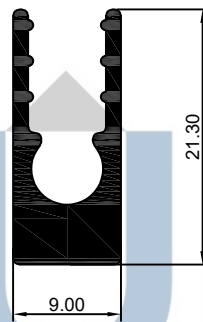

SECTION NO: 31019

0.423 Kg/m.

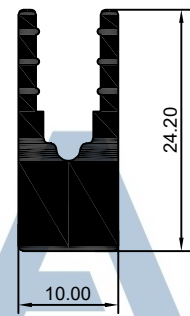

SECTION NO: 31021

0.124 Kg/m.

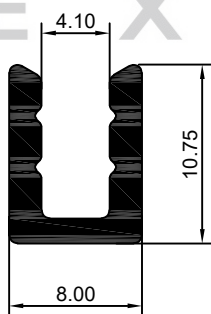

SECTION NO: 31022

0.194 Kg/m.

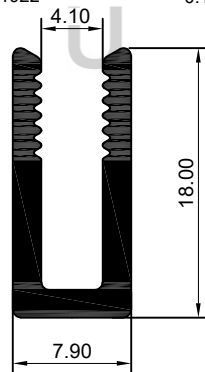

SECTION NO: 31045

0.196 Kg/m.

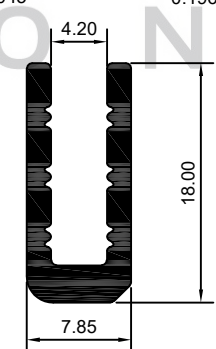

SECTION NO: 31047

0.308 Kg/m.

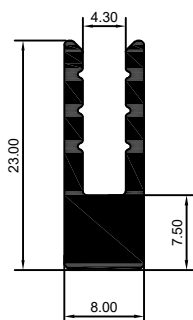

SECTION NO: 31048

0.151 Kg/m.

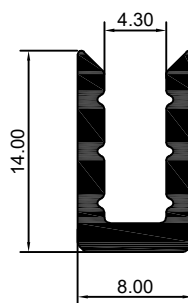

SECTION NO: 31050

0.522 Kg/m.

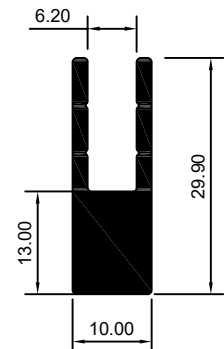

TEXTILE SECTIONS

SECTION NO: 31064

0.126 Kg/m.

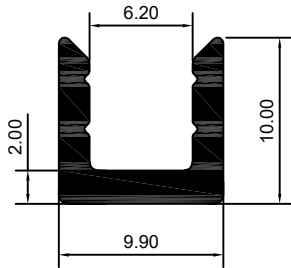

SECTION NO: 31065

0.227 Kg/m.

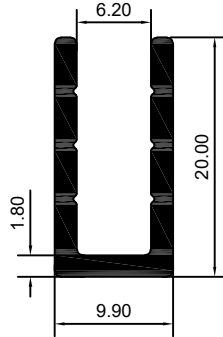

SECTION NO: 31067

0.600 Kg/m.

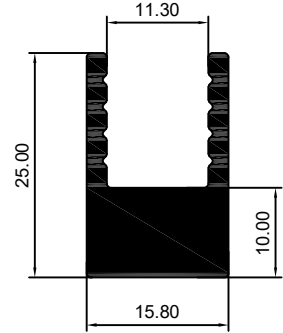

SECTION NO: 31068

0.313 Kg/m.

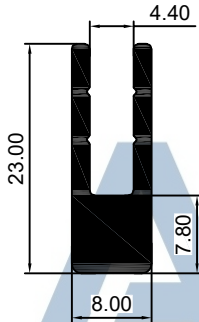

ALUKA
EXTRUSION

TEXTILE SECTIONS

SECTION NO: 31004

0.887 Kg/m.

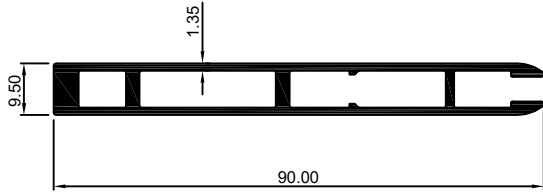

SECTION NO: 31009

0.996 Kg/m.

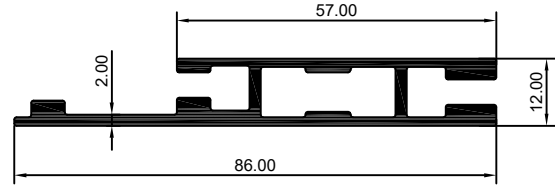

SECTION NO: 31010

1.278 Kg/m.

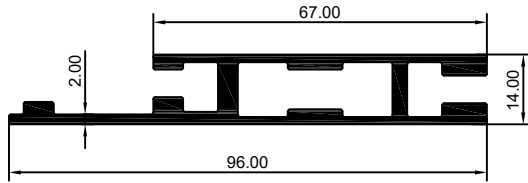

SECTION NO: 31014

0.823 Kg/m.

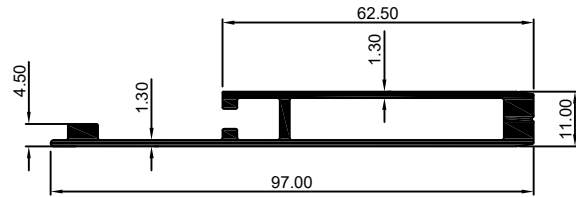

SECTION NO: 31015

0.971 Kg/m.

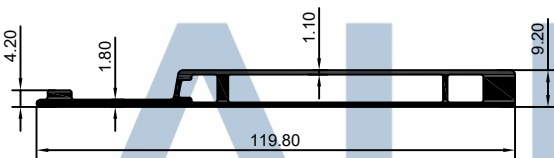

SECTION NO: 31016

0.905 Kg/m.

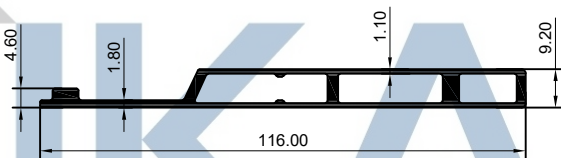

SECTION NO: 31017

0.941 Kg/m.

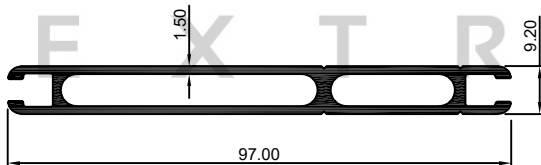

SECTION NO: 31020

1.118 Kg/m.

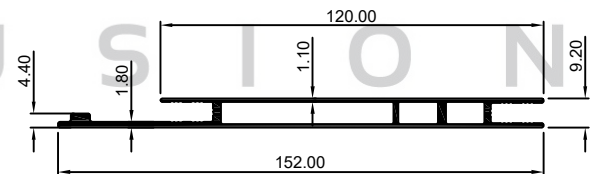

SECTION NO: 31023

0.906 Kg/m.

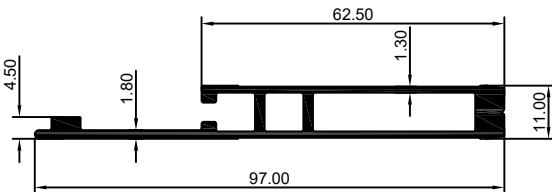

SECTION NO: 31029

1.020 Kg/m.

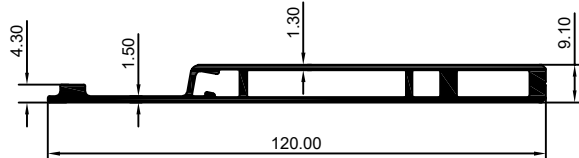

SECTION NO: 31036

1.164 Kg/m.

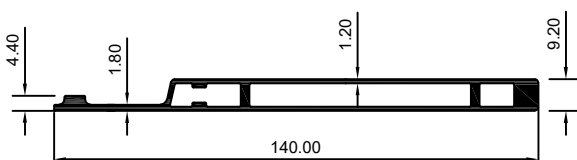

SECTION NO: 31042

0.813 Kg/m.

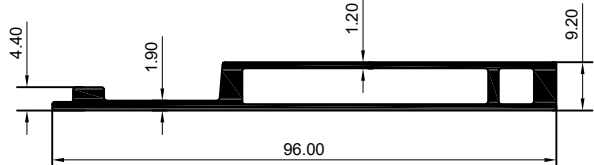

TEXTILE SECTIONS

SECTION NO: 31043

1.002 Kg/m.

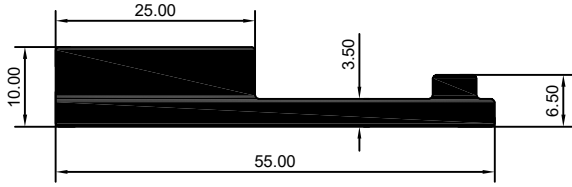

SECTION NO: 31044

0.867 Kg/m.

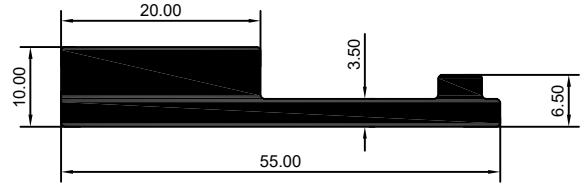

SECTION NO: 31066

1.458 Kg/m.

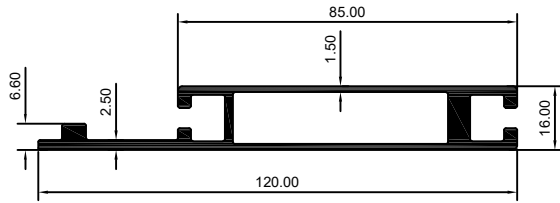

ALUKA

EXTRUSION

SOLAR SECTIONS

SECTION NO: 31501

0.799 Kg/m.

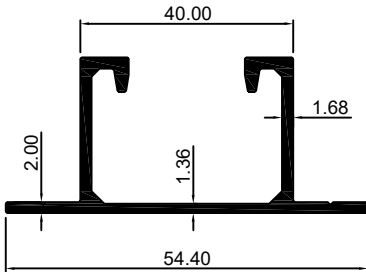

SECTION NO: 31502

0.391 Kg/m.

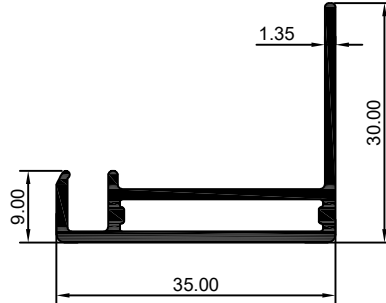

SECTION NO: 31503

0.382 Kg/m.

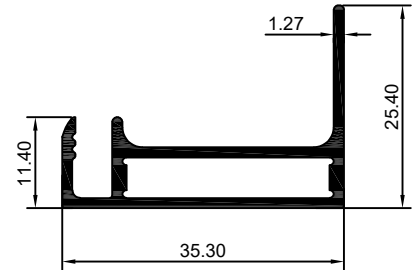

SECTION NO: 31504

0.933 Kg/m.

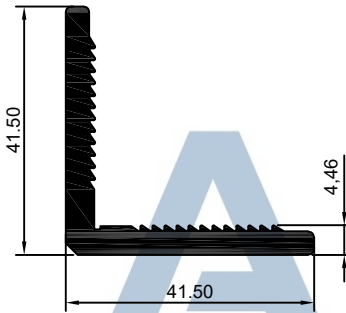

SECTION NO: 31505

0.396 Kg/m.

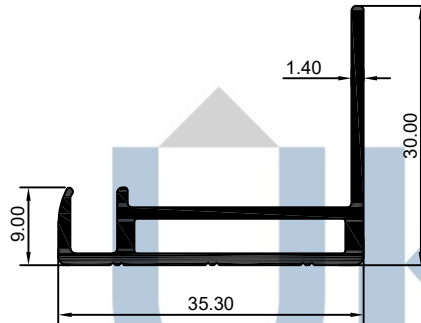

SECTION NO: 31506

0.366 Kg/m.

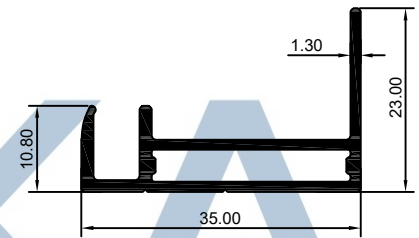

SECTION NO: 31507

0.463 Kg/m.

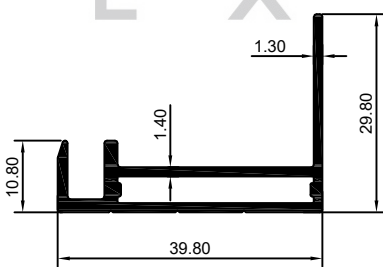

SECTION NO: 31508

0.417 Kg/m.

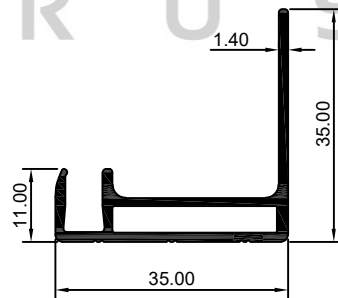

SECTION NO: 31509

0.406 Kg/m.

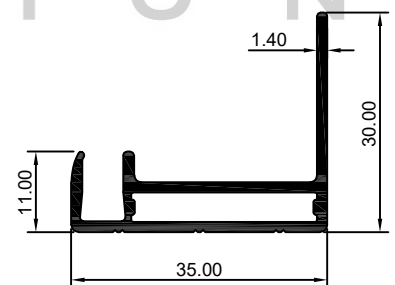

SECTION NO: 31510

0.713 Kg/m.

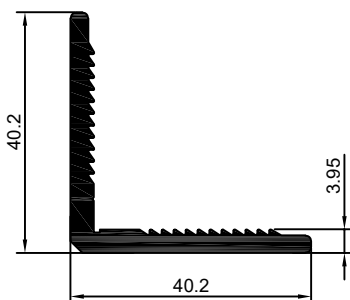

SECTION NO: 31511

0.456 Kg/m.

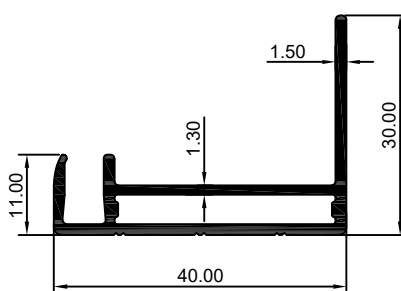

SECTION NO: 31512

0.713 Kg/m.

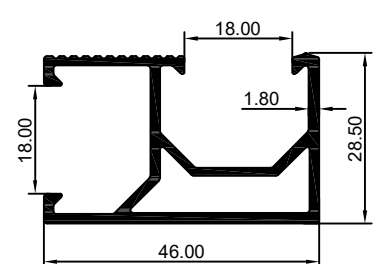

SOLAR SECTIONS

SECTION NO: 31513

0.413 Kg/m.

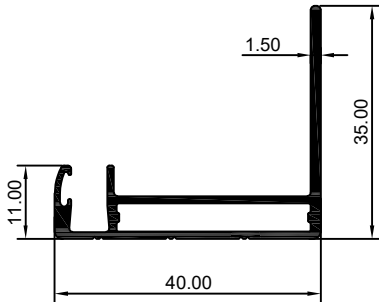

SECTION NO: 31514

0.720 Kg/m.

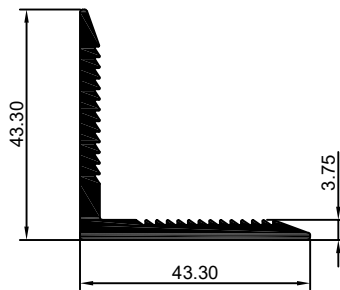

SECTION NO: 31515

0.668 Kg/m.

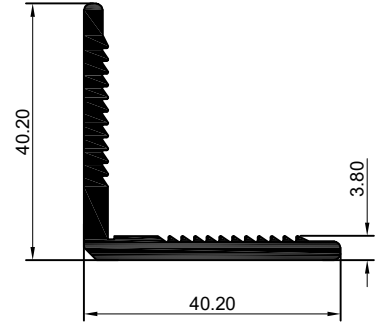

SECTION NO: 31516

0.425 Kg/m.

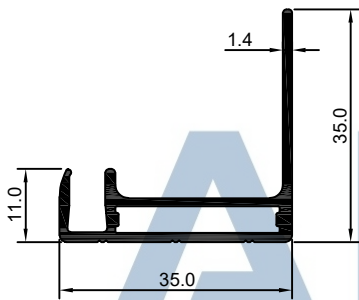

SECTION NO: 31517

0.460 Kg/m.

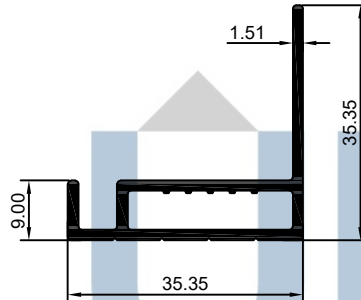

SECTION NO: 31518

0.933 Kg/m.

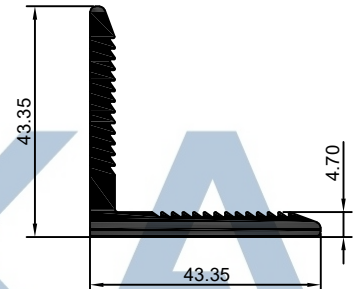

SECTION NO: 31519

0.406 Kg/m.

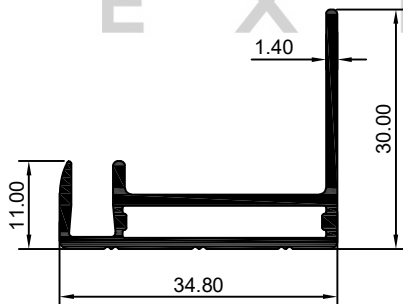

SECTION NO: 31520

0.795 Kg/m.

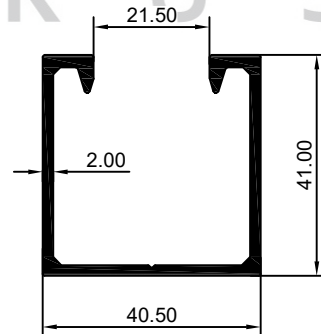

SECTION NO: 31521

1.932 Kg/m.

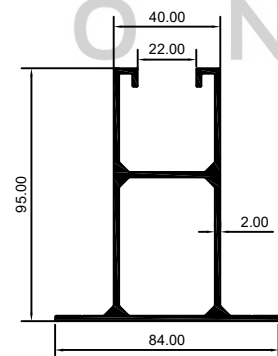

SECTION NO: 31522

0.399 Kg/m.

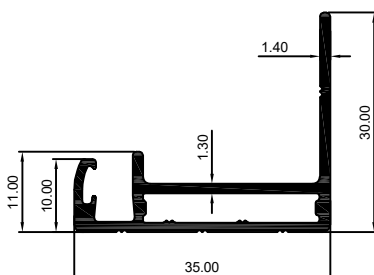

SECTION NO: 31523

1.562 Kg/m.

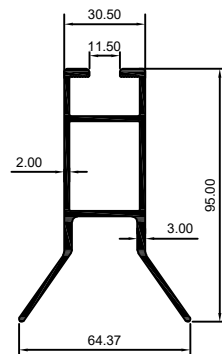

SECTION NO: 31524

1.134 Kg/m.

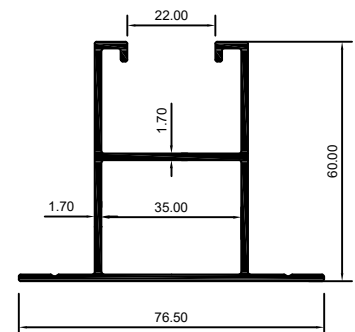

AHU SECTIONS

SECTION NO: 32201

0.543 Kg/m.

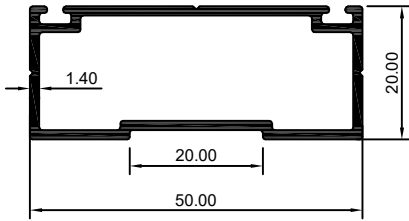

SECTION NO: 32202

0.789 Kg/m.

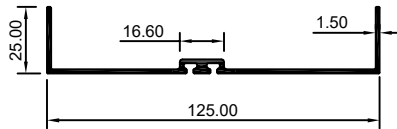

SECTION NO: 32203

1.231 Kg/m.

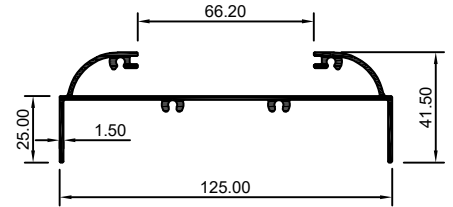

SECTION NO: 32204

0.864 Kg/m.

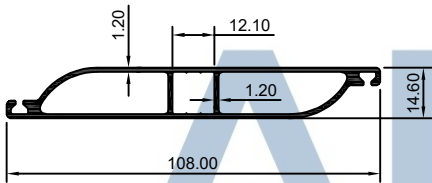

SECTION NO: 32205

0.892 Kg/m.

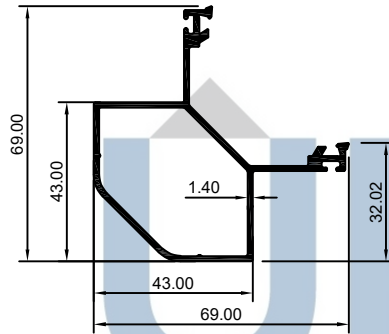

E X T R U S I O N

INDUSTRIAL SECTIONS

PAGE - 01

SECTION NO: 32501

1.981 Kg/m.

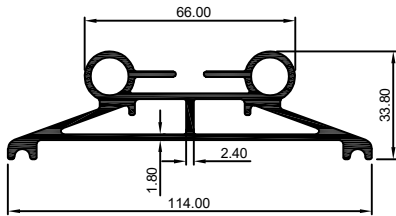

SECTION NO: 32504

7.523 Kg/m.

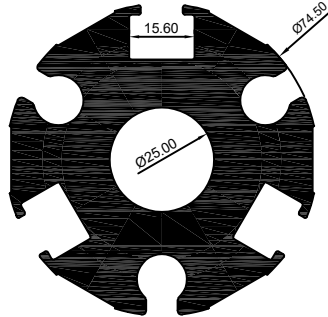

SECTION NO: 32505

0.983 Kg/m.

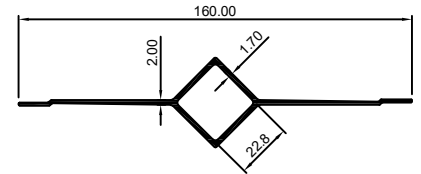

SECTION NO: 32507

2.539 Kg/m.

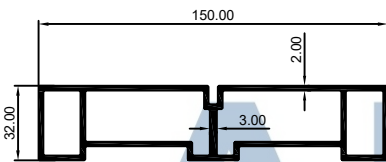

SECTION NO: 32509

0.495 Kg/m.

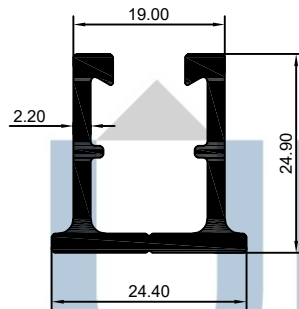

SECTION NO: 32510

0.897 Kg/m.

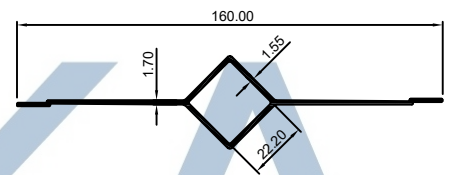

SECTION NO: 32511

1.942 Kg/m.

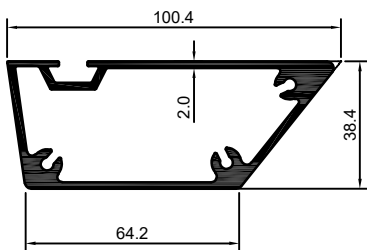

SECTION NO: 32519

0.577 Kg/m.

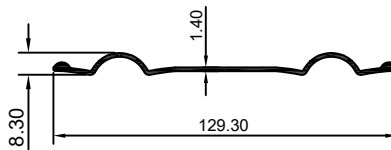

SECTION NO: 32521

0.169 Kg/m.

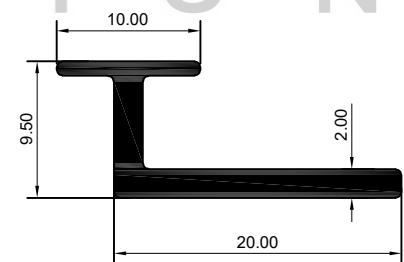

SECTION NO: 32525

1.163 Kg/m.

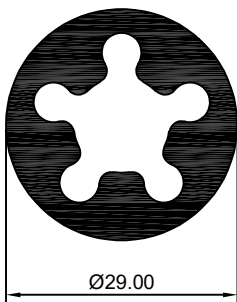

SECTION NO: 32528

1.323 Kg/m.

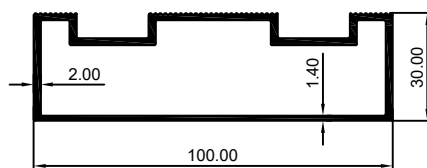

SECTION NO: 32529

1.936 Kg/m.

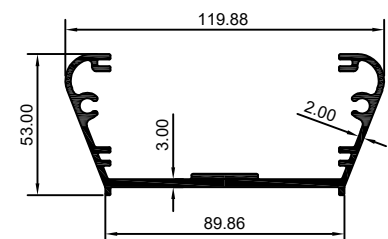

ALL DIMENSIONS ARE IN MM.

INDUSTRIAL SECTIONS

SECTION NO: 32526

2.098 Kg/m.

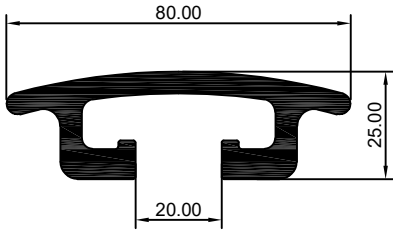

SECTION NO: 32527

2.080 Kg/m.

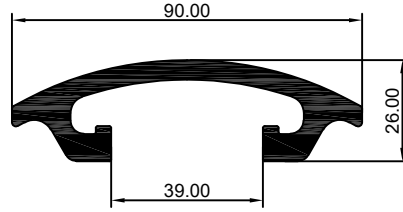

SECTION NO: 32554

2.253 Kg/m.

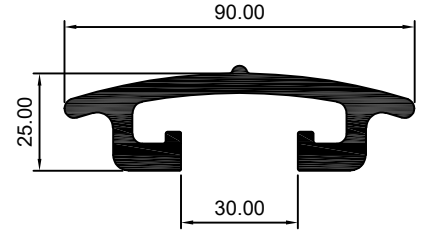

SECTION NO: 32531

1.586 Kg/m.

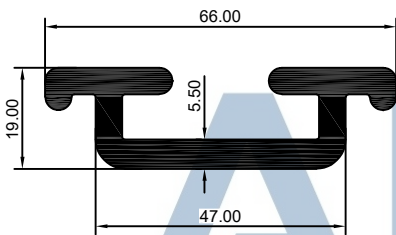

SECTION NO: 32530

3.340 Kg/m.

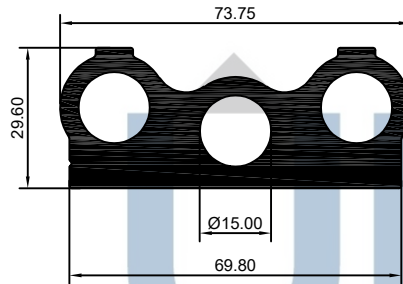

SECTION NO: 32533

3.095 Kg/m.

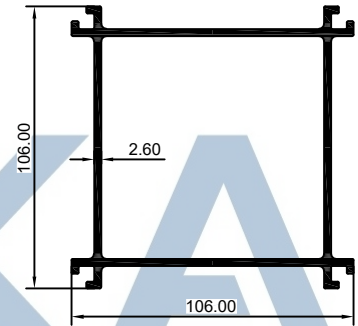

SECTION NO: 32534

4.982 Kg/m.

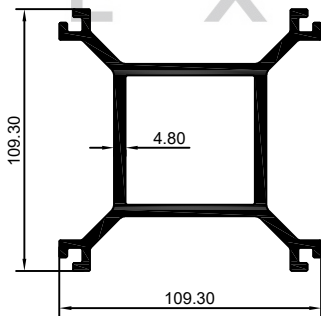

SECTION NO: 32535

2.820 Kg/m.

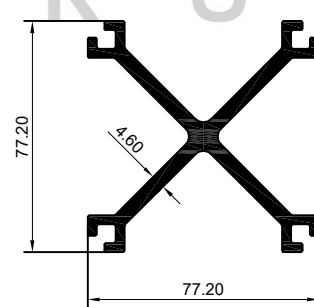

SECTION NO: 32536

1.837 Kg/m.

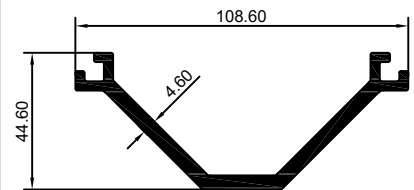

SECTION NO: 32537

2.439 Kg/m.

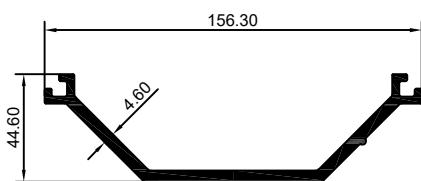

SECTION NO: 32548

3.718 Kg/m.

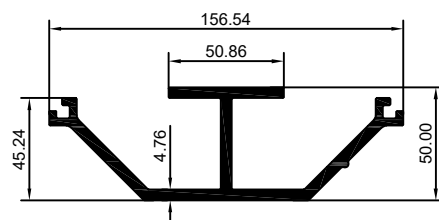

SECTION NO: 32538

0.341 Kg/m.

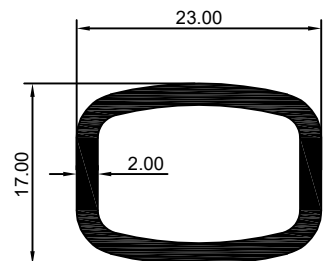

INDUSTRIAL SECTIONS

SECTION NO: 32539

0.640 Kg/m.

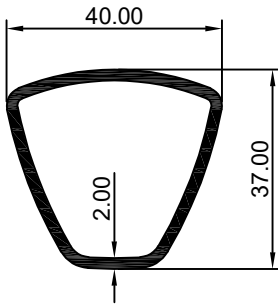

SECTION NO: 32540

0.912 Kg/m.

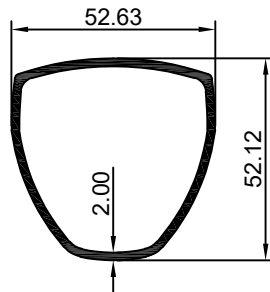

SECTION NO: 32618

0.883 Kg/m.

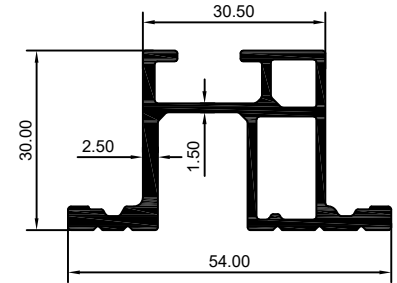

SECTION NO: 32619

1.400 Kg/m.

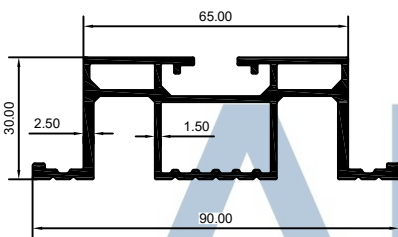

SECTION NO: 32546

5.229 Kg/m.

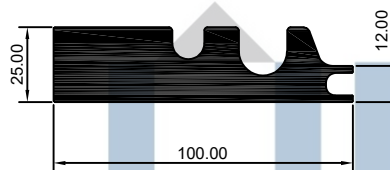

SECTION NO: 32557

3.546 Kg/m.

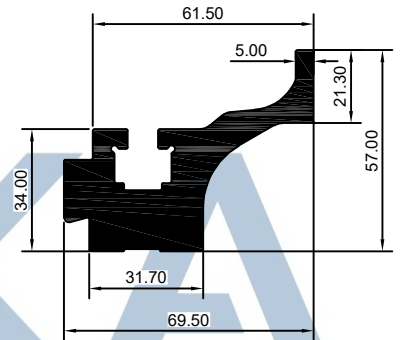

SECTION NO: 32566

2.388 Kg/m.

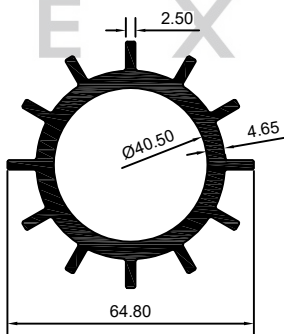

SECTION NO: 32569

0.145 Kg/m.

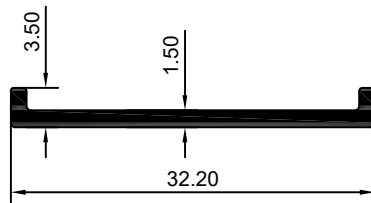

SECTION NO: 32570

0.149 Kg/m.

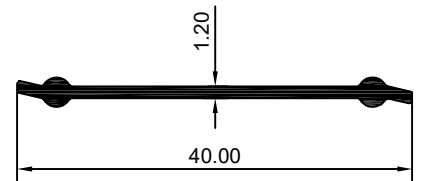

SECTION NO: 32580

0.167 Kg/m.

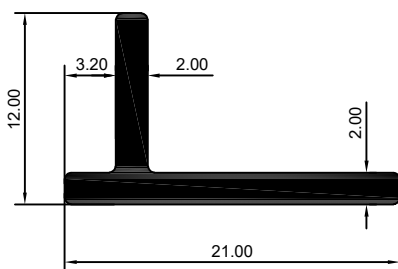

SECTION NO: 32581

0.167 Kg/m.

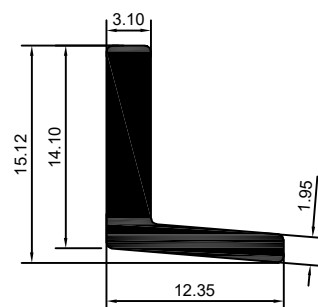

SECTION NO: 32582

2.645 Kg/m.

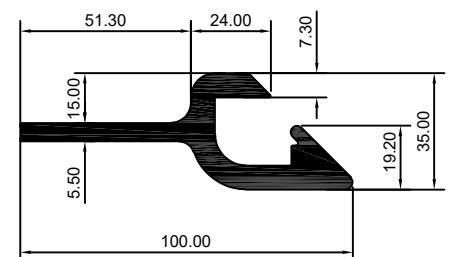

INDUSTRIAL SECTIONS

SECTION NO: 32583

4.758 Kg/m.

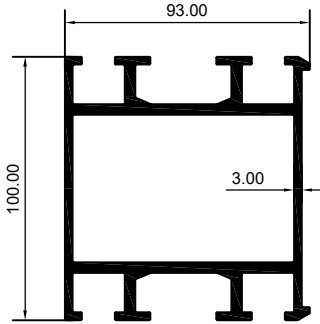

SECTION NO: 32605

0.456 Kg/m.

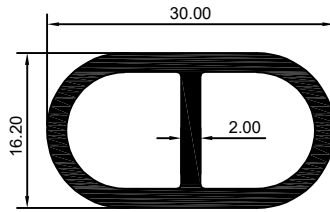

SECTION NO: 32610

0.380 Kg/m.

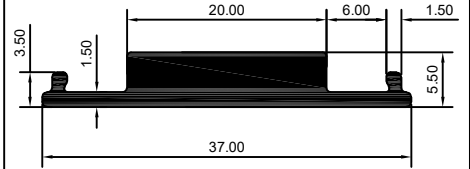

SECTION NO: 32611

1.043 Kg/m.

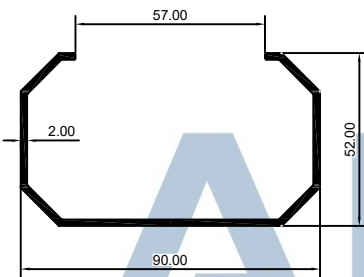

SECTION NO: 32625

1.553 Kg/m.

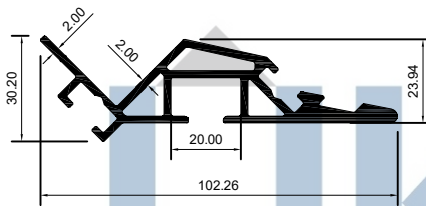

SECTION NO: 32628

0.627 Kg/m.

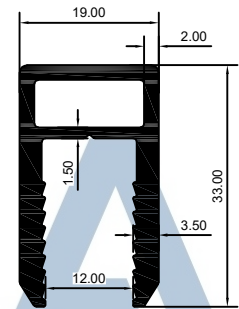

SECTION NO: 32629

0.777 Kg/m.

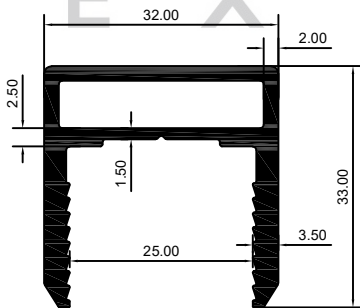

SECTION NO: 32636

2.711 Kg/m.

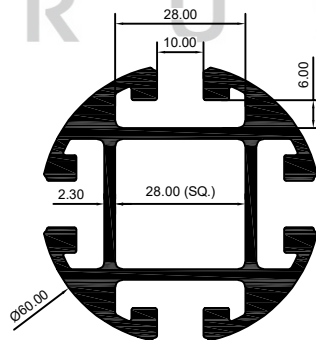

SECTION NO: 32649

2.665 Kg/m.

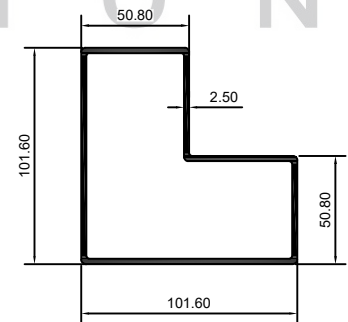

SECTION NO: 32650

0.877 Kg/m.

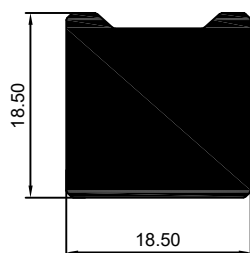

SECTION NO: 32652

0.435 Kg/m.

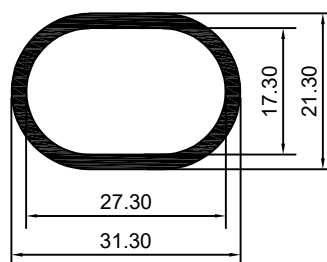

SECTION NO: 32656

3.970 Kg/m.

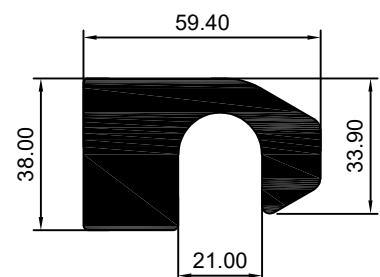

INDUSTRIAL SECTIONS

SECTION NO: 32658

1.126 Kg/m.

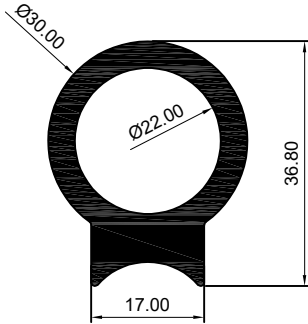

SECTION NO: 32664

4.018 Kg/m.

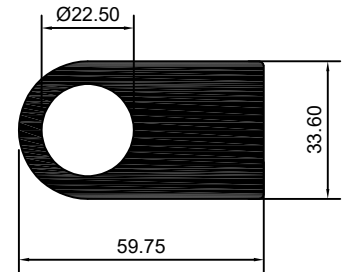

NO.	SEC. NO.	A	B	WT.MTR.
01	32661	18.50	10.50	0.445 Kg/m.
02	32662	20.80	13.20	0.503 Kg/m.

SECTION NO: 32673

6.306 Kg/m.

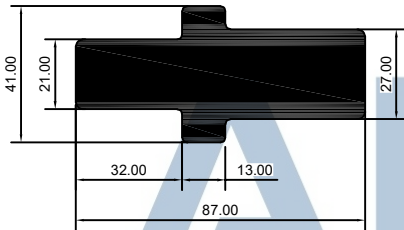

SECTION NO: 32674

5.582 Kg/m.

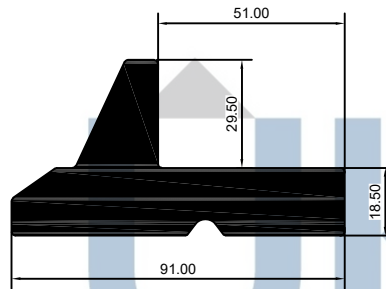

SECTION NO: 32679

0.426 Kg/m.

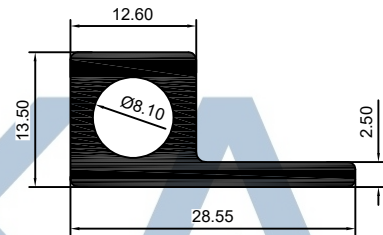

SECTION NO: 32683

0.821 Kg/m.

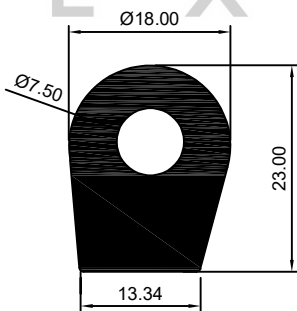

SECTION NO: 32684

5.888 Kg/m.

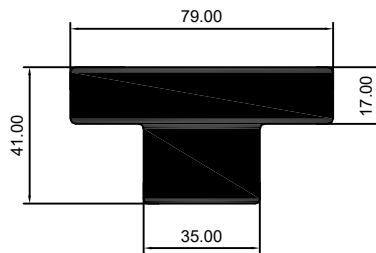

SECTION NO: 32685

0.860 Kg/m.

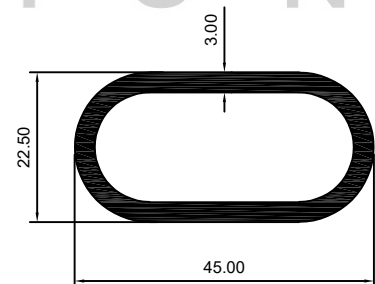

SECTION NO: 32686

0.959 Kg/m.

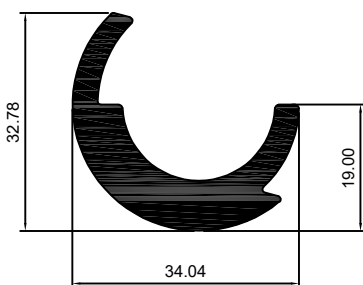

SECTION NO: 32687

1.411 Kg/m.

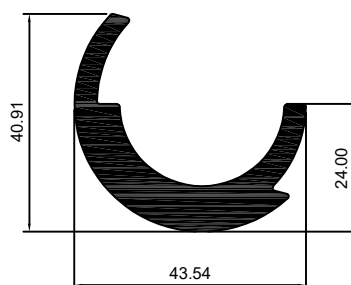

SECTION NO: 32688

1.837 Kg/m.

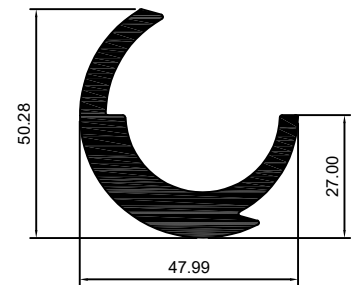

INDUSTRIAL SECTIONS

SECTION NO: 32691

4.572 Kg/m.

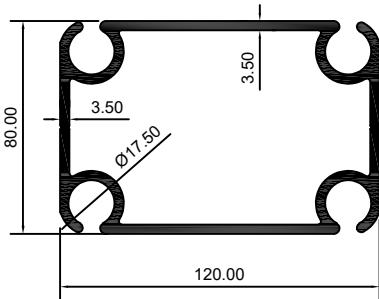

SECTION NO: 32693

1.381 Kg/m.

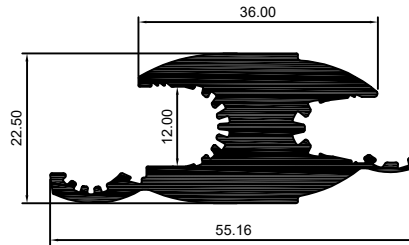

SECTION NO: 32694

0.906 Kg/m.

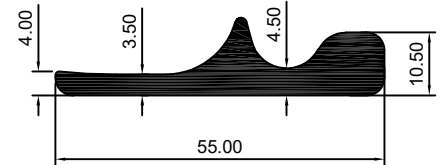

SECTION NO: 32696

0.330 Kg/m.

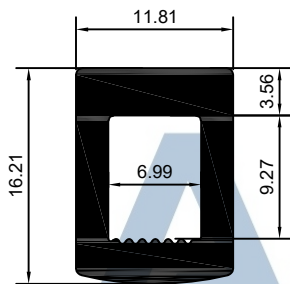

SECTION NO: 32697

2.500 Kg/m.

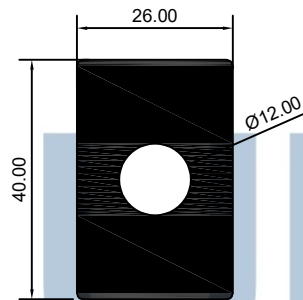

SECTION NO: 32801

0.912 Kg/m.

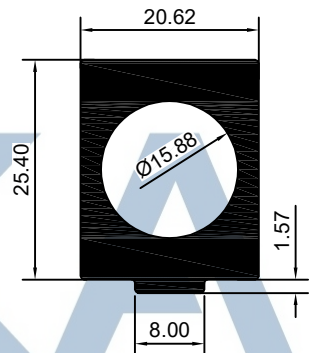

SECTION NO: 32802

0.542 Kg/m.

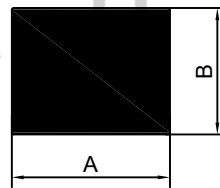
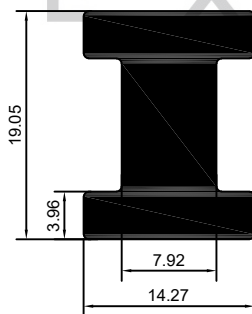

NO.	SEC. NO.	A	B	WT./MTR.
01	32805	11.13	7.92	0.237 Kg/m.
02	32803	18.54	14.22	0.711 Kg/m.
03	32804	31.75	25.40	2.177 Kg/m.

SECTION NO: 32806

0.503 Kg/m.

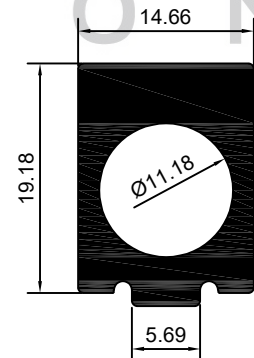

SECTION NO: 33301

0.550 Kg/m.

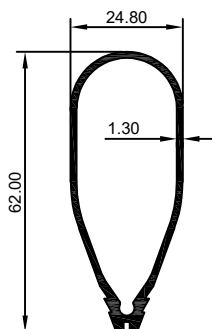

SECTION NO: 33302

0.165 Kg/m.

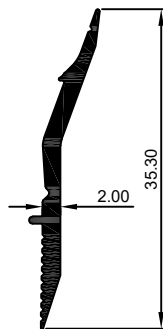

SECTION NO: 33303

1.732 Kg/m.

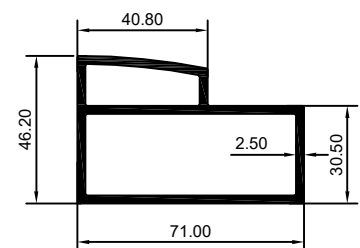

L - SECTIONS

SECTION NO: 32663

2.369 Kg/m.

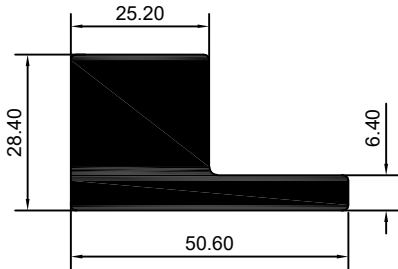

SECTION NO: 32666

2.392 Kg/m.

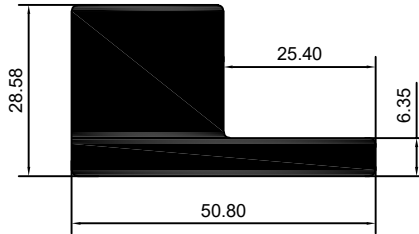

SECTION NO: 32667

5.121 Kg/m.

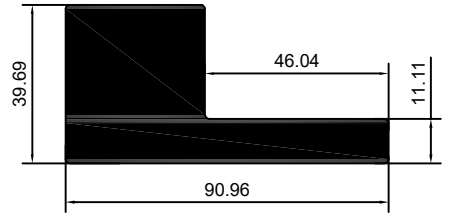

SECTION NO: 32668

5.227 Kg/m.

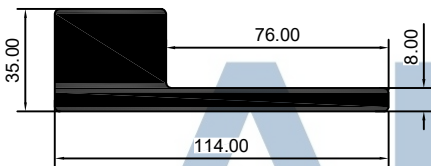

SECTION NO: 32669

8.783 Kg/m.

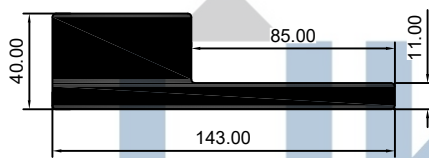

SECTION NO: 32670

1.132 Kg/m.

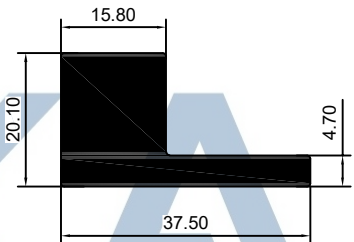

SECTION NO: 32672

10.553 Kg/m.

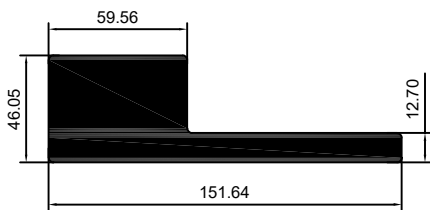

SECTION NO: 32701

0.915 Kg/m.

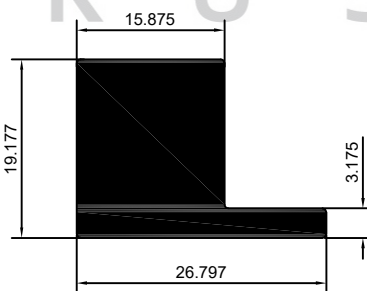

SECTION NO: 32702

0.568 Kg/m.

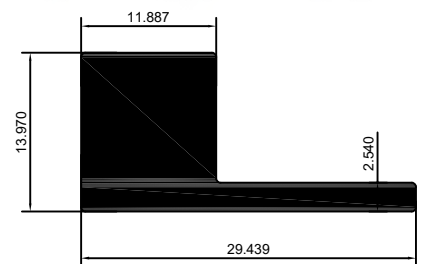

SECTION NO: 32703

2.014 Kg/m.

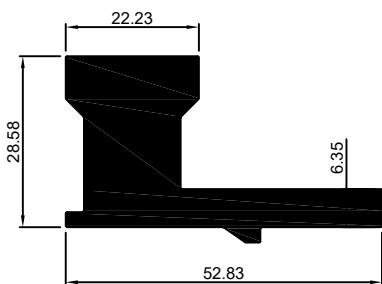

SECTION NO: 32704

1.081 Kg/m.

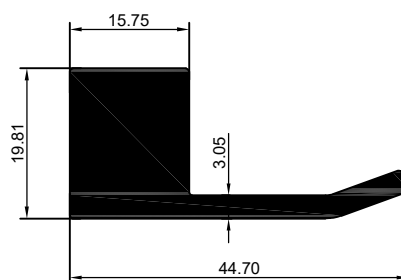

SECTION NO: 32705

5.372 Kg/m.

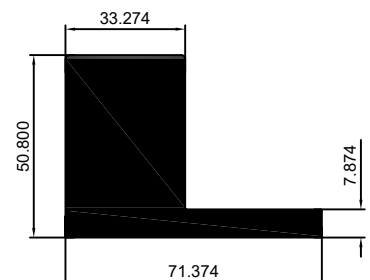

L - SECTIONS

SECTION NO: 32706

5.915 Kg/m.

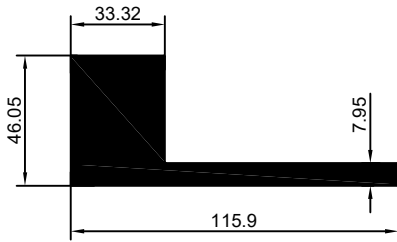

SECTION NO: 32707

2.338 Kg/m.

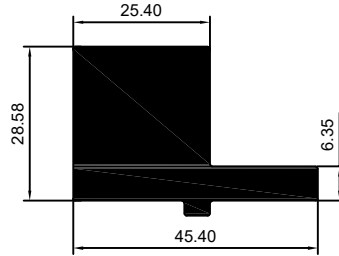

SECTION NO: 32708

1.132 Kg/m.

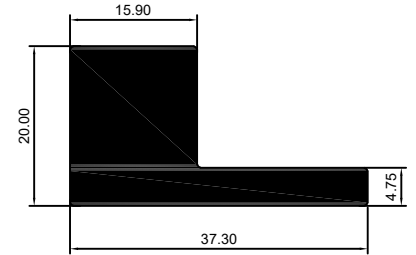

SECTION NO: 32709

6.264 Kg/m.

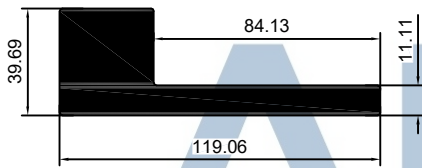

SECTION NO: 32710

8.204 Kg/m.

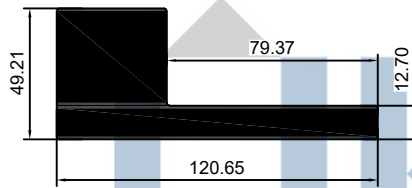

SECTION NO: 32711

7.000 Kg/m.

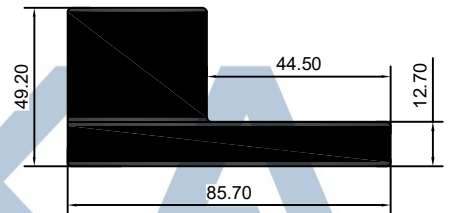

EXTRUSION

HEAT SINK SECTIONS

SECTION NO: 33001

1.809 Kg/m.

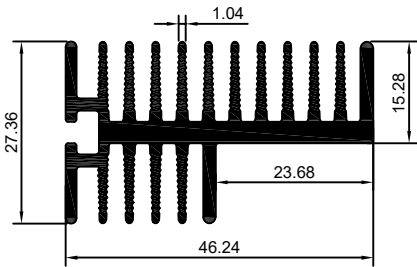

SECTION NO: 33003

2.108 Kg/m.

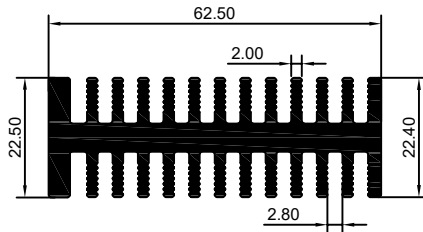

SECTION NO: 33004

0.848 Kg/m.

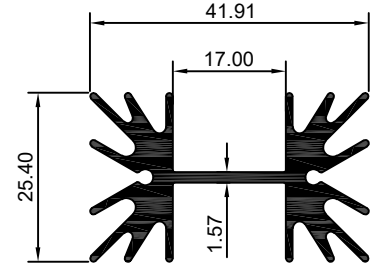

SECTION NO: 33005

0.196 Kg/m.

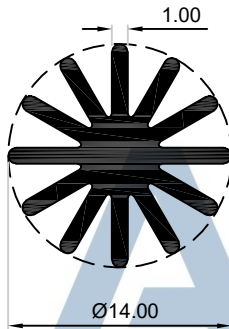

SECTION NO: 33006

6.874 Kg/m.

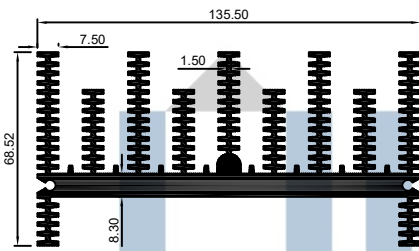

SECTION NO: 33013

0.479 Kg/m.

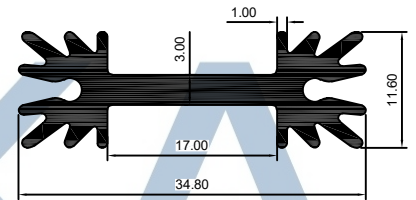

E X T R U S I O N

BUS BODY SECTIONS

PAGE - 01

SECTION NO: 33501

0.160 Kg/m.

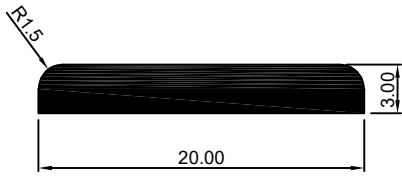

SECTION NO: 33502

0.527 Kg/m.

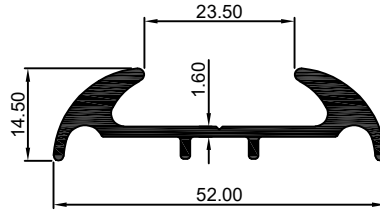

SECTION NO: 33503

0.171 Kg/m.

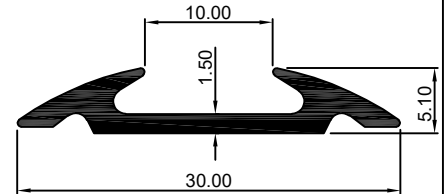

SECTION NO: 33504

0.330 Kg/m.

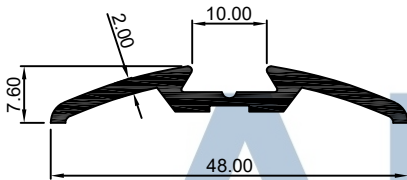

SECTION NO: 33505

0.254 Kg/m.

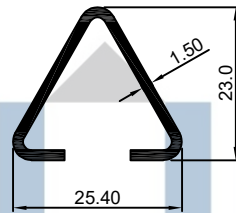

SECTION NO: 33506

0.845 Kg/m.

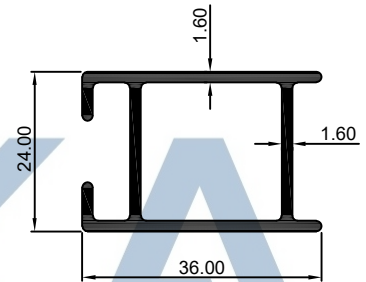

SECTION NO: 33507

0.666 Kg/m.

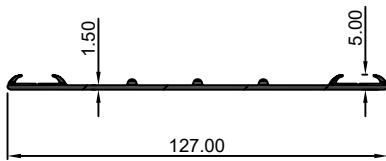

SECTION NO: 33508

0.710 Kg/m.

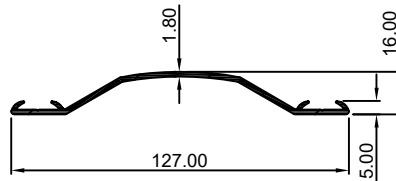

SECTION NO: 33509

0.766 Kg/m.

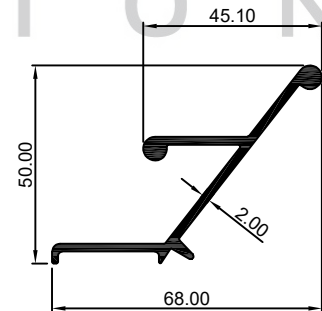

SECTION NO: 33510

0.340 Kg/m.

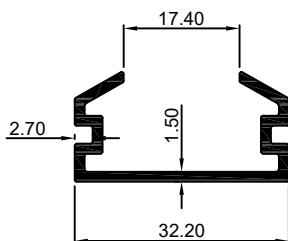

SECTION NO: 33511

0.479 Kg/m.

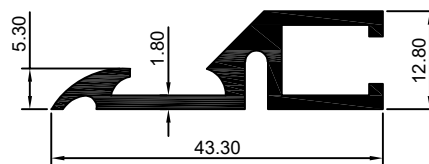

SECTION NO: 33512

1.140 Kg/m.

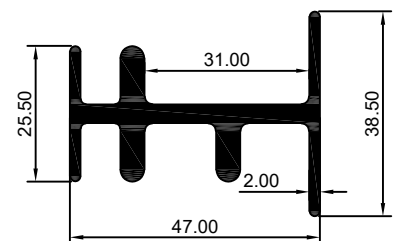

ALL DIMENSIONS ARE IN MM.

BUS BODY SECTIONS

SECTION NO: 33513

0.705 Kg/m.

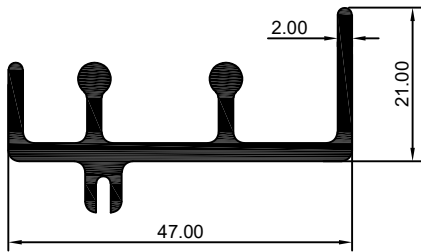

SECTION NO: 33514

0.525 Kg/m.

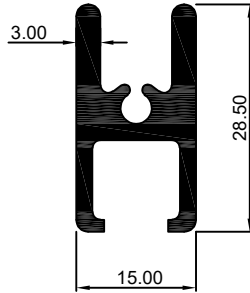

SECTION NO: 33515

0.269 Kg/m.

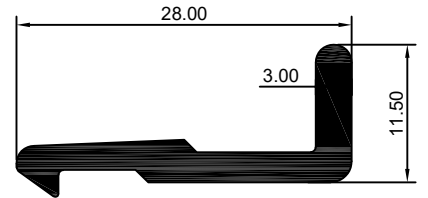

SECTION NO: 33516

0.700 Kg/m.

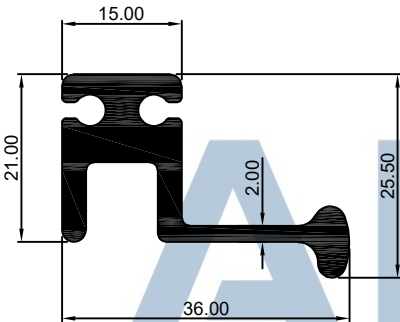

SECTION NO: 33517

0.515 Kg/m.

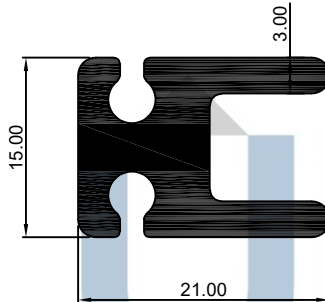

SECTION NO: 33518

0.332 Kg/m.

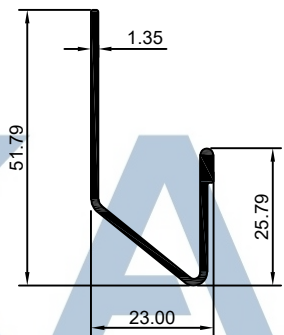

SECTION NO: 33519

0.572 Kg/m.

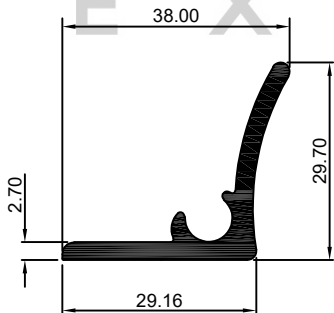

SECTION NO: 33520

0.428 Kg/m.

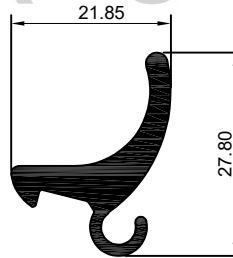

SECTION NO: 33521

0.300 Kg/m.

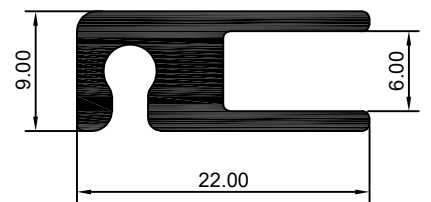

SECTION NO: 33522

0.560 Kg/m.

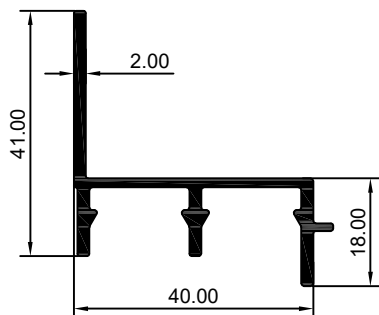

SECTION NO: 33523

1.064 Kg/m.

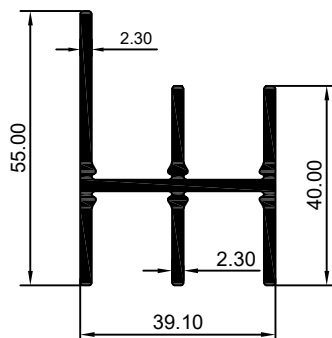

SECTION NO: 33524

0.346 Kg/m.

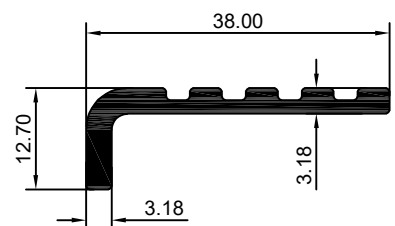

BUS BODY SECTIONS

SECTION NO: 33525

0.253 Kg/m.

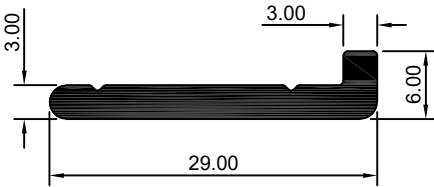

SECTION NO: 33526

0.195 Kg/m.

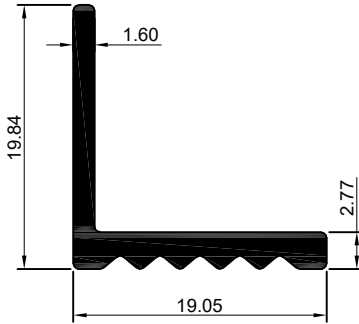

SECTION NO: 33527

0.152 Kg/m.

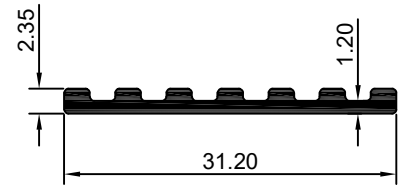

SECTION NO: 33528

1.660 Kg/m.

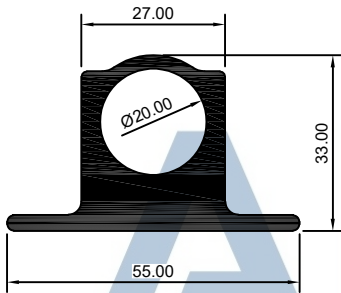

SECTION NO: 33529

0.359 Kg/m.

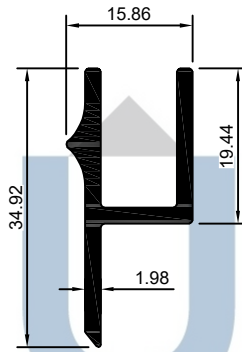

SECTION NO: 33530

0.493 Kg/m.

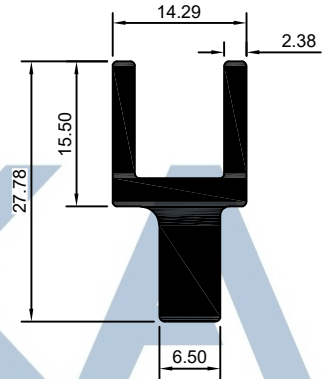

SECTION NO: 33531

0.336 Kg/m.

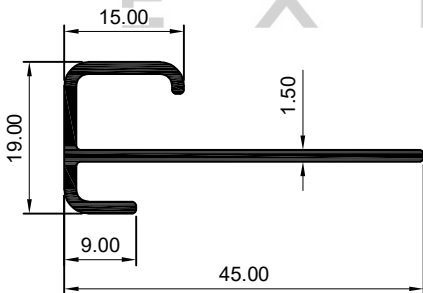

SECTION NO: 33532

0.372 Kg/m.

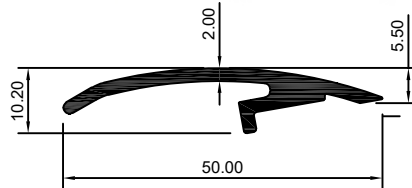

SECTION NO: 33533

0.568 Kg/m.

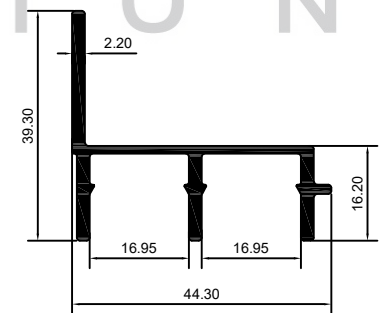

SECTION NO: 33534

0.650 Kg/m.

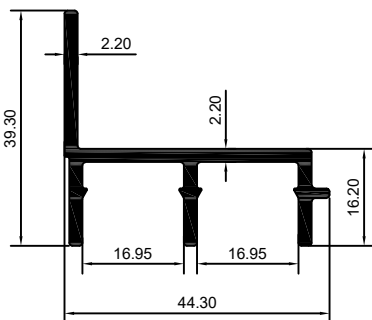

SECTION NO: 33535

1.368 Kg/m.

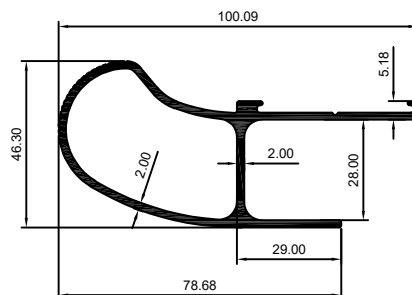

SECTION NO: 33536

0.201 Kg/m.

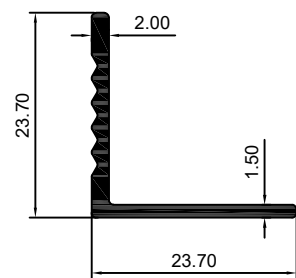

BUS BODY SECTIONS

SECTION NO: 33537

0.235 Kg/m.

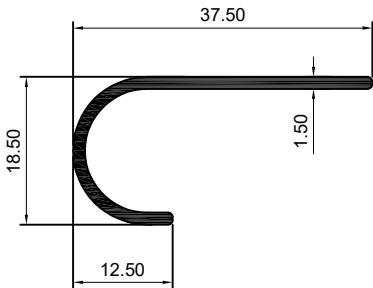

SECTION NO: 33538

0.205 Kg/m.

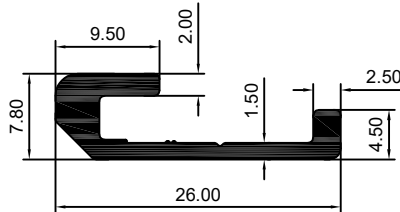

SECTION NO: 33539

0.166 Kg/m.

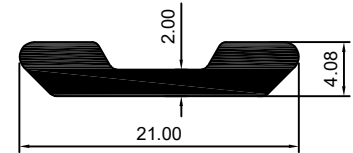

SECTION NO: 33540

0.445 Kg/m.

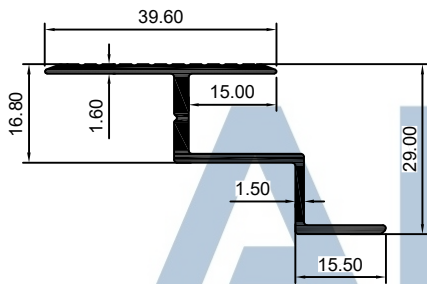

SECTION NO: 33541

0.317 Kg/m.

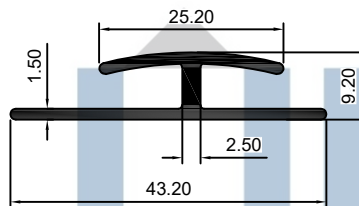

SECTION NO: 33542

3.591 Kg/m.

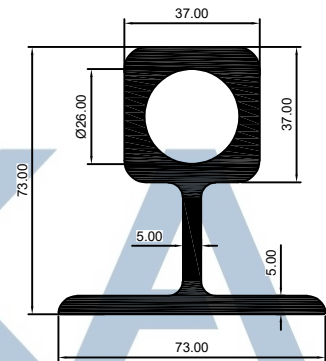

E X T R U S I O N

RAIL SECTIONS

SECTION NO: 33851

0.800 Kg/m.

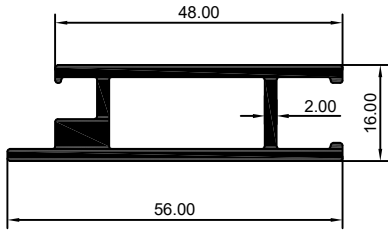

SECTION NO: 33852

0.604 Kg/m.

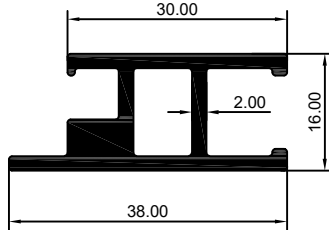

SECTION NO: 33853

0.431 Kg/m.

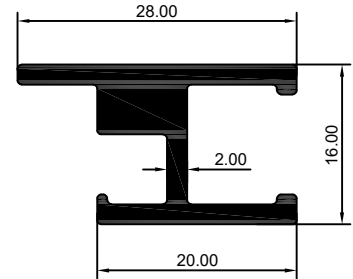

SECTION NO: 33854

1.430 Kg/m.

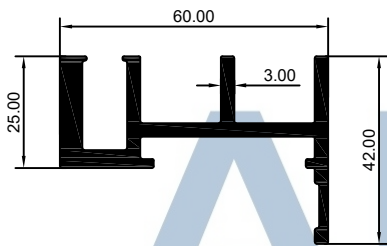

SECTION NO: 33855

1.309 Kg/m.

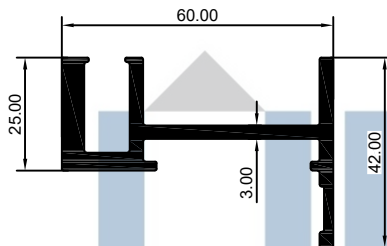

SECTION NO: 33856

1.550 Kg/m.

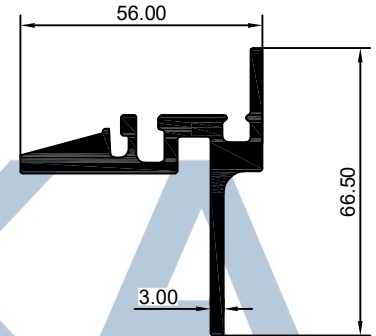

SECTION NO: 33857

1.201 Kg/m.

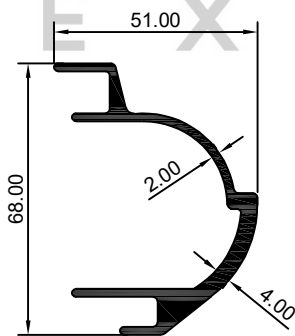

SECTION NO: 33860

0.681 Kg/m.

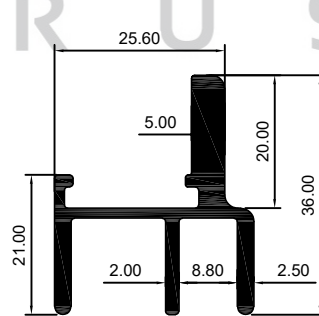

SECTION NO: 33861

0.235 Kg/m.

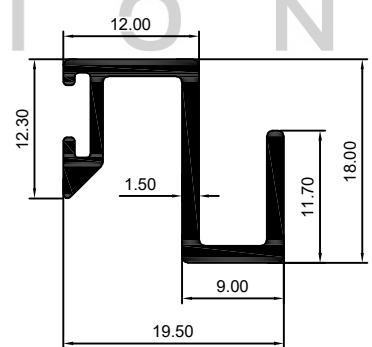

SECTION NO: 33862

0.460 Kg/m.

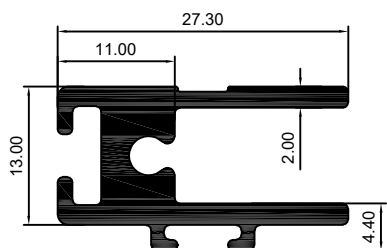

SECTION NO: 33863

1.732 Kg/m.

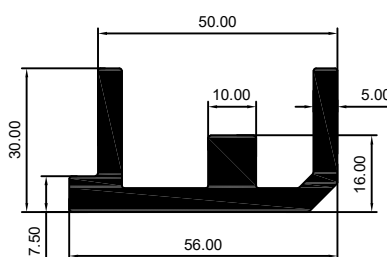

SECTION NO: 33864

0.750 Kg/m.

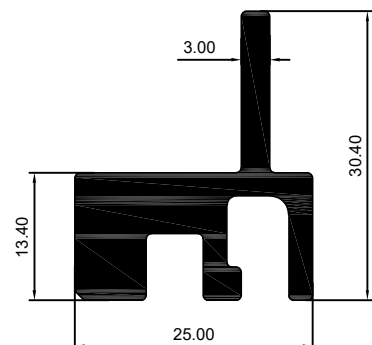

ALL DIMENSIONS ARE IN MM.

MOTOR BODY SECTIONS

SECTION NO: 34004

5.840 Kg/m.

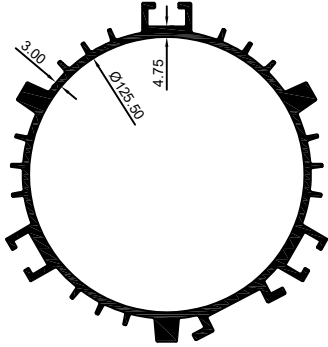

SECTION NO: 34005

15.544 Kg/m.

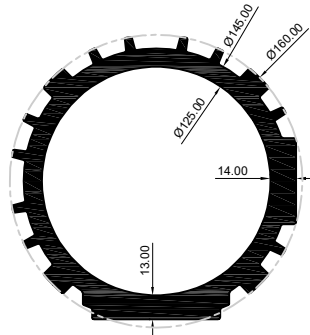

SECTION NO: 34006

8.238 Kg/m.

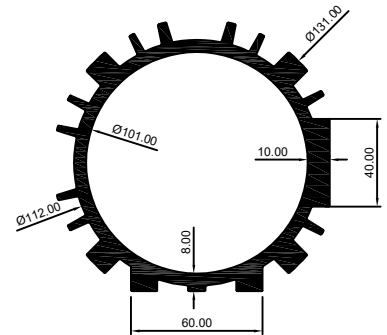

ALUKA

EXTRUSION

BUILT FOR INDUSTRIES THAT VALUE PREDICTABILITY

Automotive & Auto Components
LED & Electrical Applications
Industrial & Engineering Applications

Architectural & Structural Systems
Defence & Specialised Projects
Solar & Energy Solutions

If you are evaluating **Aluminium Extrusion Partners**, start with the right technical conversations.

Connect with our engineering team.

WHY BUYERS CHOOSE US?

Consistency beyond first approvals and samples
Clear communication across development and production
Controlled processes that reduce rework and delivery risk
A long-term, partnership-led manufacturing approach



ISO 9001:2015



IATF 16949:2016



ZED GOLD



ALUKA
EXTRUSION

Customised Aluminium Extrusion Solutions

FACTORY: Survey No. 783/P, Nr. Freight Systems, Mankol-Makhiyav Road, Sanand-Nalsarovar Road, Sanand, A'bad - 382110
OFFICE: B 305, Titanium Heights, Opp. Vodafone Tower, Corporate Road, Ahmedabad - 380015. Gujarat. India.

+91 79 48992145 | info@alukaextrusion.com | www.alukaextrusion.com